

# Mounting components



Festo core product range  
Covers 80% of your automation tasks

Worldwide:  
Superb:  
Easy:

Always in stock  
Festo quality at an attractive price  
Simplified procurement and warehousing

- ★ Generally ready for dispatch from the factory within 24 hours  
In stock at 13 Service Centres worldwide  
More than 2200 products
- ★ Generally ready for dispatch from the factory within 5 days  
Assembled for you at 4 Service Centres worldwide  
Up to  $6 \times 10^{12}$  variants per product family

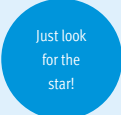

## Data sheet

### Centring pin ZBS

Material:  
Corrosion-resistant steel  
Free of copper and PTFE  
RoHS-compliant

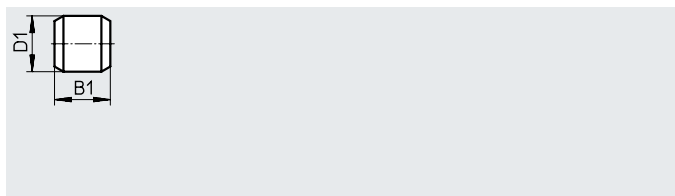

Dimensions and ordering data							
D1 ∅	B1	CRC <sup>1)</sup>	Weight [g]	Part no.	Type	PU <sup>2)</sup>	
h8	-0.2						
2	5	2	1	525273	ZBS-2	10	
4	5	2	1	562959	ZBS-4		
5	5	2	1	150928	ZBS-5		

- 1) Corrosion resistance class CRC 2 to Festo standard FN 940070  
Moderate corrosion stress. Internal applications in which condensation can occur. External visible parts with primarily decorative surface requirements which are in direct contact with a normal industrial environment.
- 2) Packaging unit

### Centring sleeve ZBH

Material:  
Corrosion-resistant steel  
Free of copper and PTFE  
RoHS-compliant

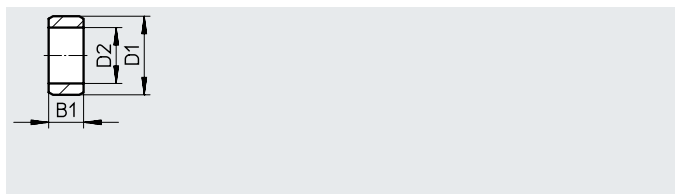

Dimensions and ordering data							
D1 ∅	B1	D2 ∅	CRC <sup>1)</sup>	Weight [g]	Part no.	Type	PU <sup>2)</sup>
	-0.2						
5 <sub>h7</sub>	2.4	3.2	2	1	189652	ZBH-5	10
5 <sub>h8</sub>	2.4	4.2	2	1	8119593	ZBH-5-M4	
7 <sub>h7</sub>	3	5.3	2	1	186717	ZBH-7	
15 <sub>h7</sub>	6	12.4	2	3	191409	ZBH-15	
25 <sub>h7</sub>	6.9	17	2	4	8023856	ZBH-25	

- 1) Corrosion resistance class CRC 2 to Festo standard FN 940070  
Moderate corrosion stress. Internal applications in which condensation can occur. External visible parts with primarily decorative surface requirements which are in direct contact with a normal industrial environment.
- 2) Packaging unit

### Centring sleeve ZBH-...-B

Material:  
Corrosion-resistant steel  
Free of copper and PTFE  
RoHS-compliant

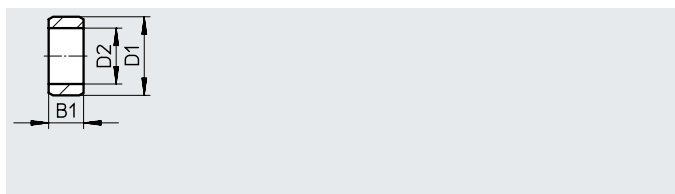

Dimensions and ordering data							
D1 <sup>1)</sup> ∅	B1	D2 ∅	CRC <sup>2)</sup>	Weight [g]	Part no.	Type	PU <sup>3)</sup>
	±0.1						
5	2.3	3.6	2	1	8146543	ZBH-5-B	10
7	2.9	5.6	2	1	8146544	ZBH-7-B	
9	3.9	6.4	2	1	8137184	ZBH-9-B	
12	4.9	10.3	2	1	8137185	ZBH-12-B	

- 1) Diameter suitable for installation space H7
- 2) Corrosion resistance class CRC 2 to Festo standard FN 940070  
Moderate corrosion stress. Internal applications in which condensation can occur. External visible parts with primarily decorative surface requirements which are in direct contact with a normal industrial environment.
- 3) Packaging unit
- † - Note: The centring sleeves ZBH-...-B will be slightly pretensioned during assembly due to their slotted shape.