

PNA Nozzles

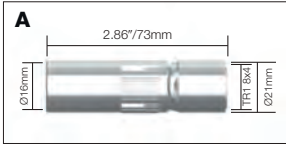

| Stock Code | Description | Bore | Model |
|------------|-------------|-----------|---------|
| A TGN00038 | Nozzle | 16mm/5/8" | PNA350A |



| Stock Code | Description | Bore | Model |
|------------|-------------|-----------|---------|
| B TGN00050 | Nozzle | 19mm/3/4" | PNA500A |

PNA Contact Tips

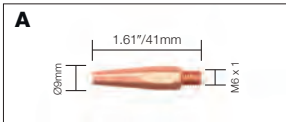

| Stock Code | Description | Wire Size | Material | Model |
|------------|-------------|-------------|----------|-------|
| A TET00844 | Contact Tip | 0.8mm/.030" | CuCrZr | Range |
| TET01072 | Contact Tip | 1.0mm/.040" | CuCrZr | Range |
| TET12010 | Contact Tip | 1.2mm/.045" | CuCrZr | Range |

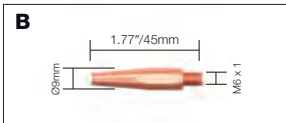

| Stock Code | Description | Wire Size | Material | Model |
|------------|-------------|-------------|----------|-------|
| B TET00842 | Contact Tip | 0.8mm/.030" | CuCrZr | Range |
| TET01068 | Contact Tip | 1.0mm/.040" | CuCrZr | Range |
| TET01297 | Contact Tip | 1.2mm/.045" | CuCrZr | Range |

PNA Tip Adaptors

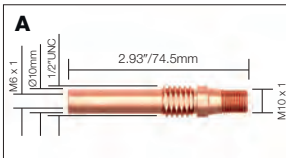

| Stock Code | Description | Tip Thread | Model |
|------------|-------------|------------|---------|
| A TEB35116 | Tip Adaptor | M6 | PNA350A |

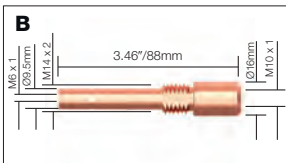

| Stock Code | Description | Tip Thread | Model |
|------------|-------------|------------|---------|
| B U4173G21 | Tip Adaptor | M6 | PNA500A |

PNA 500A

Air Cooled MIG Welding Torch

500A CO₂, 450A Mixed Gas @ 60% Duty Cycle, EN60974-7 .040"-1/16"/1.0mm to 1.6mm Wire

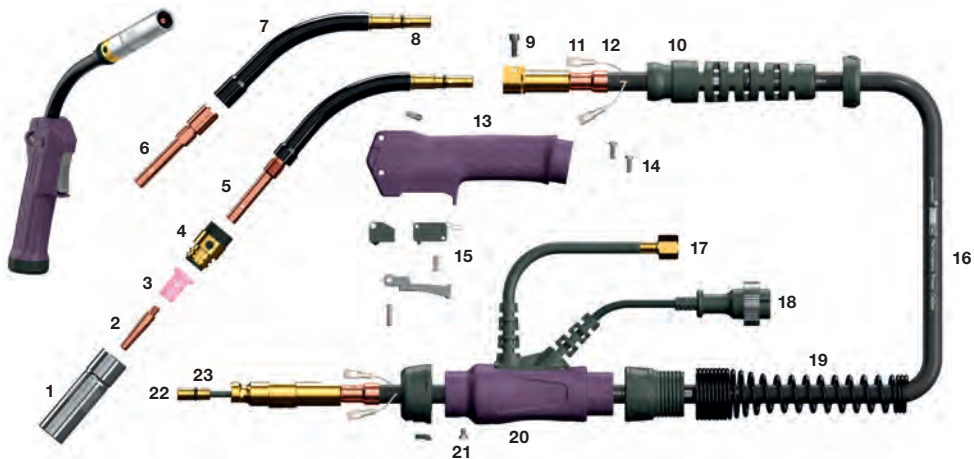

Model

| Stock Code | Description |
|-------------|------------------------------------------|
| YT-50CSS | Torch Package x 3m c/w PNA Termination |
| YT-50CSM3 | Torch Package x 4.5m c/w PNA Termination |
| YT-50CSL3 | Torch Package x 6m c/w PNA Termination |
| YT-50CS3ER | Torch Package x 3m c/w Euro Fitting |
| YT-50CSM3ER | Torch Package x 4.5m c/w Euro Fitting |
| YT-50CSL3ER | Torch Package x 6m c/w Euro Fitting |

Components

* Denotes Standard Build

| Stock Code | Description |
|--------------|-------------------------------------------|
| 1 TGN00050 | Nozzle 19mm |
| 2 TET00842 | Contact Tip .030"/0.8mm |
| TET01068 | Contact Tip .040"/1.0mm |
| TET01297 | Contact Tip .045"/1.2mm |
| 3 TGR00902 | Gas Diffuser |
| 4 TFZ50107 | Insulator |
| 5 TCX00006 | Torch Body Assembly Solid |
| 6 U4173G21 | Tip Adaptor Screw On |
| 7 U5353B00 | Torch Body Assembly Screw On Adaptor Type |
| 8 P8-4D70N | 'O' Ring |
| 9 XVE5A15 | Torch Body Locking Screw |
| 10 PA8015 | Cable Support c/w Knuckle Joint |
| 11 PA1521 | Switch Wire Terminal-Female |
| 12 PA1521-C | Switch Wire Terminal Cover |
| 13 TSMH0022 | PNA Handle Kit |
| 14 PA1513 | Handle Fixing Screw Kit |
| 15 AH70690F | Microswitch c/w Insulation Boot |
| 16 PA5009-30 | Cable Assembly x 3m |
| PA5009-45 | Cable Assembly x 4.5m |
| PA5009-60 | Cable Assembly x 6m |
| 17 TWG18102 | Gas Hose Assembly |
| 18 TWU18101 | Switch Lead And Plug Assembly |
| 19 PA3641 | Cable Support |
| 20 TSMH0019 | PNA Termination Housing c/w Nut |
| 21 PA1526 | Housing Screw Kit |
| 22 TDT90001 | Liner Assembly x 3m (S121) |
| TDT90002 | Liner Assembly x 4.5m (S121) |
| TDT90003 | Liner Assembly x 6m (S121) |
| 23 P7-NBR7ON | 'O' Ring |