

Lodam Compressor Protection Modules

Technical manual

Version 3.0



SE-B1, B2, B3, B4

7. Technical data

| Technical specifications | | | | |
|---------------------------------|--|--------|---|---|
| Description | SE-B1 | SE-B2 | SE-B3 | SE-B4 |
| Supply voltage | 230 VAC; +10% ~ -15%, 50/60 Hz 2VA 24 VAC; +10% ~ -15%, 50/60 Hz 2VA 24 VDC; +20% ~ -20%, 50/60 Hz 1W 24 VDC version: no galvanic isolation | | 115 - 230 VAC; +10% ~ -15% 50/60 Hz 2VA | 230 VAC; +10% ~ -15%, 50/60 Hz, 2VA 24 VAC; +10% ~ -15%, 50/60 Hz, 2VA |
| Permitted ambient temperature | -30°C – +70°C | | -30°C – +60°C | |
| Relative humidity | Max. 95% RH non-condensing Electronic circuit board is coated | | | |
| Air pressure | 660 hPA to 1060 hPA | | | |
| PTC sensor cable length | 120 mm | 350 mm | | |
| Relay | 24 VAC/VDC versions Switch voltage 24 VAC/VDC Continuous current max 10 mA (gold plated contacts). If current limit is exceeded, gold plating will be destroyed and current limit is then like the other versions listed below All versions Switch voltage 250 VAC. Continuous current max 2.5A Switching capacity 300 VA, C300 (pilot type use according to UL508) | | | |
| Fuse required | Max. 4A, fast-blow | | | |
| Enclosure class | Terminals IP00 | | | |
| Field wiring markings | Wire type (Cu only, 14 – 20 AWG) Use 60°C copper conductors only | | | |
| Terminal torque rating | 6 lb-in." / 0.7 Nm or equivalent | | | Spade connection 6.3 mm * 0.8 mm / 1/4" |
| Type of sensor | PTC according to DIN 44081/44082 | | | |
| Number of sensors | 1 to 9 in series | | | |
| Max total resistance, R25 total | < 1.8 kΩ | | | |
| RTrig | 4.5 kΩ ff15% | | | |
| RReset | 2.7 kΩ ff15% | | | |
| Reset | Interrupt supply power for min. 5 seconds | | | |
| Weight | 150g; 24 VDC version: 90g | | | |
| Dimensions | 68.3 mm (w) * 32.5 mm (d) * 50 mm (h) | | | |
| Mounting | 35 mm snap-in or mounting with screws | | | |
| Housing material | PA66 - GF | | | |
| UL file number | E334756 | | | |
| Terminal wire range | Cu 60°C only, 20-14 AWG / 0.5 mm ² - 2,0 mm ² | | | |

8. Drawings

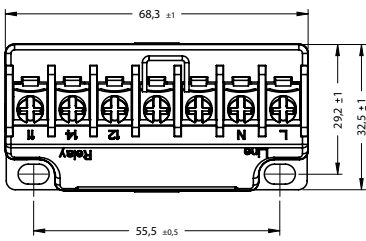
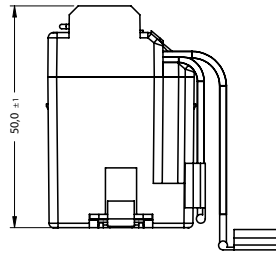
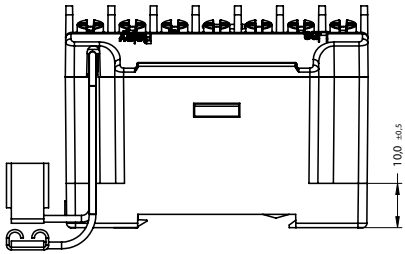

Shown without wire

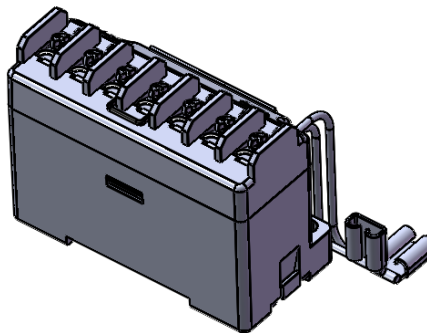

SE-B1/SE-B2/SE-B3

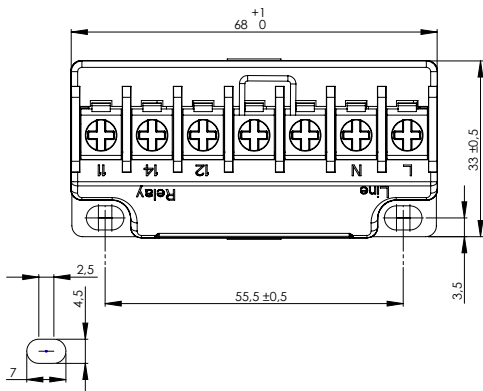
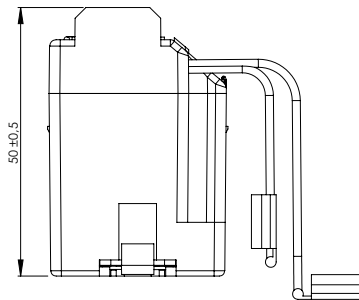
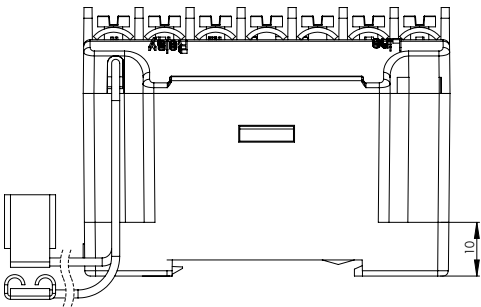

SE-B4

Mounting is for standard rail 35 mm according to DIN EN 60715.