

Symbol	Description
14	Gland cartridge
40	Gland wiperseal
41	Gland lipseal
42	Piston lipseal
43	Gland back-up washer
44	Piston back-up washer
45	Gland to head o-ring
47	End seal o-ring
48	Piston ring
62	Gland cartridge kit
119	Outer ring
120	Inner ring
121	Wear ring

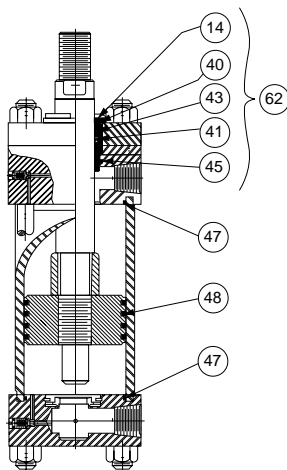

Seal Kits for Class 1 & 2 Service

(For Class 1 Hydraulic Service see TS-2000 Seal Kits pg. 50)

Material: Buna-N (Nitrile)

Operating temp.: -10½F (-23½C) to +165½F (+74½C).

Recommended for: Air, nitrogen, hydraulic (mineral) petroleum base oils, water-in-oil emulsions & water/glycol fluids.

Gland and spanner wrenches are available to ease (rod) seal or gland cartridge removal without disassembly of the cylinder.

For detailed seal replacement instructions see service bulletin #0995-M1, M2 & M3.

Rod Dia.	Series 2A, 2H, 3L & VH Cylinders			
	RG	RK	Gland Wrench	Spanner Wrench
	Gland (Sym. 62) Cartridge Kits	Rod Seal Kits		
	Contains Symbols 14, 40, 41, 43 & 45	Contains Symbols 40, 41, 43 & 45		
1/2	RG2AHL 0051	RK2AHL 0051	069590 0000	0116760000
5/8	RG2AHL 0061	RK2AHL 0061	069590 0000	011676 0000
1	RG2AHL 0101	RK2AHL 0101	069591 0000	011676 0000
1 3/8	RG2AHL 0131	RK2AHL 0131	069592 0000	011703 0000
1 3/4	RG2AHL 0171	RK2AHL 0171	069593 0000	011677 0000
2	RG2AHL 0201	RK2AHL 0201	069594 0000	011677 0000
2 1/2	RG2AHL 0251	RK2AHL 0251	069595 0000	011677 0000
3	RG2AHL 0301	RK2AHL 0301	069596 0000	011677 0000
3 1/2	RG2AHL 0351	RK2AHL 0351	069597 0000	011677 0000
4	RG2AHL 0401	RK2AHL 0401	069598 0000	011678 0000
4 1/2	RG2AHL 0451	RK2AHL 0451	083877 0000	011678 0000
*5	RG2AHL 0501	RK2AHL 0501	069599 0000	011678 0000
*5 1/2	RG2AHL 0551	RK2AHL 0551	069600 0000	011678 0000

*RG & RK kits listed are not applicable to 10" & 12" bore series 2H cylinders. See bulletin 0995-M4.

Bore Size	PK/Piston Seal Kits	PK/Piston Seal Kits	PR/Piston Ring Kits	Hi-Load Piston Seal Kits
	Series 2A Only Contains 2 Ea. Symbols: 42, 44 & 47	Series 2HL, 3LL & VHL Contains 2 Ea. Symbols: 42, 44 & 47	Series 2H, 3L & VH Contains 2 Ea. Sym. 47 & 48	Series 2H & VH Contains 2 Ea. Symbols 47, 119, 120 & 121
1	PK1002A001	PK102HLL01	PR102H0001	-
1 1/2	PK1502A001	PK152HLL01	PR152H0001	PK152HK001
2	PK2002A001	PK202HLL01	PR202H0001	PK202HK001
2 1/2	PK2502A001	PK252HLL01	PR252H0001	PK252HK001
3 1/4	PK3202A001	PK322HLL01	PR322H0001	PK322HK001
4	PK4002A001	PK402HLL01	PR402H0001	PK402HK001
5	PK5002A001	PK502HLL01	PR502H0001	PK502HK001
6	PK6002A001	PK602HLL01	PR602H0001	PK602HK001
7	PK7002A001	PK702HLL01	PR702H0001	PK702HK001
8	PK8002A001	PK802HLL01	PR802H0001	PK802HK001
10	PK9002A001	PK902HLL01	PR902H0001	PK902HK001
12	PK9202A001	PK922HLL01	PR922H0001	PK922HK001
14	PK9402A001	-	-	-

Piston Seal Options

Ring Type Piston

(as shown above)
 Supplied as standard on series 2H, 3L & VH hydraulic cylinders.

Lipseal Type Piston

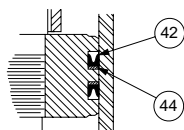

Supplied as standard on series 2A air cylinders.
 Optional for series 2H, 3L & VH hydraulic cylinders.

Hi-Load Type Piston

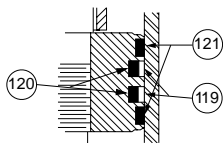

Optional on series 2H & VH hydraulic cylinders. Not available on series 2A & 3L cylinders.

Bore Size	CB Cylinder Body Seal Kits		Tie Rod Torque Specifications*			
	Series 2A	Series 2H, 3L & VH	Series 2A & 3L			Series 2H & VH
	Contains 2 EA. Symbol 47	Contains 2 Ea. Symbol 47	Cylinder Body Material			Steel
1	CB102HL001	CB102HL001	Brass	Steel	Fiberglass	Steel
1-1/2	CB152HL001	CB152HL001	12 in.-lbs. 14 cm-kg	35 in.-lbs. 41 cm-kg	-	-
2	CB202HL001	CB202HL001	36 in.-lbs. 42 cm-kg	60 in.-lbs. 69 cm-kg	-	18 ft.-lbs. 24 N.m
2-1/2	CB252HL001	CB252HL001	72 in.-lbs. 83 cm-kg	11 ft.-lbs. 15 N.m	-	45 ft.-lbs. 61 N.m
3-1/4	CB322A0001	CB322HL001	72 in.-lbs. 83 cm-kg	11 ft.-lbs. 15 N.m	-	45 ft.-lbs. 61 N.m
4	CB402A0001	CB402HL001	18 ft.-lbs. 24 N.m	25 ft.-lbs. 34 N.m	-	131 ft.-lbs. 178 N.m
5	CB502A0001	CB502HL001	44 ft.-lbs. 50 N.m	60 ft.-lbs. 81 N.m	-	312 ft.-lbs. 423 N.m
6	CB602A0001	CB602HL001	44 ft.-lbs. 50 N.m	60 ft.-lbs. 81 N.m	-	528 ft.-lbs. 716 N.m
7	CB702A0001	CB702HL001	-	90 ft.-lbs. 122 N.m	-	800 ft.-lbs. 1085 N.m
8	CB802A0001	CB802HL001	80 ft.-lbs. 108 N.m	110 ft.-lbs. 149 N.m	-	1168 ft.-lbs. 1584 N.m
10	CB902A0001	CB902HL001	113 ft.-lbs. 153 N.m	148 ft.-lbs. 201 N.m	78 (ft. Lbs.) 106 N.m	-
12	CB922A0001	CB922HL001	148 ft.-lbs. 201 N.m	172 ft.-lbs. 233 N.m	78 (ft. Lbs.) 106 N.m	-
14	-	-	228 ft.-lbs. 309 N.m	275 ft.-lbs. 373 N.m	118 (ft. Lbs.) 160 N.m	-

*(-0%, +5% tolerance). When assembling the cylinder, be sure to torque the tie rods evenly.

How to order – individual seals contained in the kits are available separately – however we recommend purchasing complete kits because of the convenience & lower replacement cost. When ordering seal kits give part number listed above. To be sure of exact replacement, give serial number of cylinder when ordering replacement kits or seals.

For additional information – call your local Parker Cylinder Distributor.