

Compact Cylinder Series *NCQ8*

Bore size: 056(9/16"), 075(3/4"), 106(1 1/16"), 150(1 1/2")
200(2"), 250(2 1/2"), 300(3"), 400(4")



Now available in 300 (3") and 400 (4") bore sizes

Standard type	Actuation	Style	Built-in magnet	Rod end male thread	With rubber bumper	Bore size	Standard stroke (in)	Page
	Double acting	Single rod	○	○	○	056(9/16") 075(3/4") 106(1 1/16") 150(1 1/2") 200(2") 250(2 1/2") 300(3")** 400(4")**	012(1/8"), 025(1/4"), 037(3/8"), 050(1/2"), 062(5/8"), 075(3/4"), 087(7/8"), 100(1"), 125(1 1/4"), 150(1 1/2"), 175(1 3/4"), 200(2"), 250(2 1/2"), 300(3"), 350(3 1/2"), 400(4")	1
		Double rod	○	○	○			13
	Single acting	Single rod	○	○	○			012(1/8"), 025(1/4"), 037(3/8"), 050(1/2"), 062(5/8"), 075(3/4"), 087(7/8"), 100(1"), 125(1 1/4"), 150(1 1/2"), 175(1 3/4"), 200(2")
Super Compact	Actuation	Style	Built-in magnet	Rod end male thread	With rubber bumper	Bore size	Standard stroke (in)	Page
	Double acting	Single rod	★	○	○	056(9/16") 075(3/4") 106(1 1/16") 150(1 1/2") 200(2") 250(2 1/2") 300(3")** 400(4")**	025(1/4"), 037(3/8"), 050(1/2"), 062(5/8"), 075(3/4"), 087(7/8"), 100(1"), 125(1 1/4"), 150(1 1/2"), 175(1 3/4"), 200(2"), 250(2 1/2"), 300(3"), 350(3 1/2"), 400(4")	1
	Single acting	Single rod	★	○	○			025(1/4"), 037(3/8"), 050(1/2"), 062(5/8"), 075(3/4"), 087(7/8"), 100(1"), 125(1 1/4"), 150(1 1/2"), 175(1 3/4"), 200(2")

Note) Built-in magnet type has a minimum stroke of 025 (1/4").

★ Super Compact type is only available with a magnet.

★★ 300 (3") and 400 (4"): Available for double acting type only.

Compact Cylinder Double Acting, Double Rod *Series NCQ8W*

Construction

Without auto switch

With auto switch

Male thread

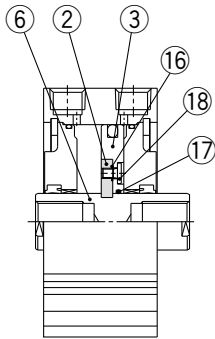

For stroke
012(1/8")~075(3/4")

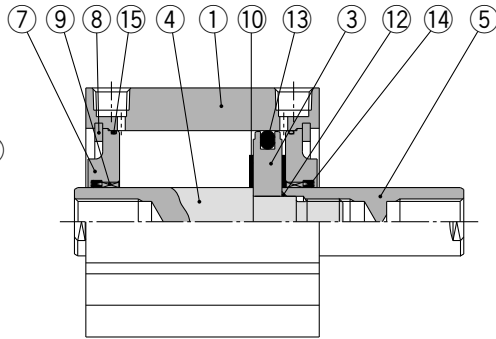

For stroke 087(7/8")~400(4")

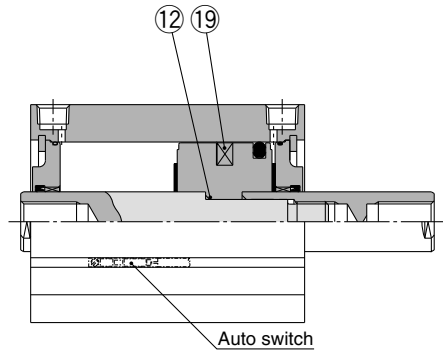

Auto switch

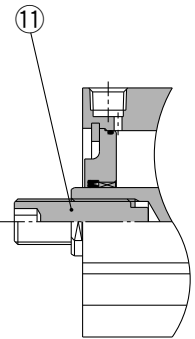

Parts List

No.	Description	Material	Remarks
1	Cylinder tube	Aluminum alloy	Hard anodized
2	Piston Ring	Stainless steel	300 and 400 only
3	Piston	Aluminum alloy	Chromated
4	Piston Rod A	Stainless steel	056 to 106
		Carbon steel	150 to 400, Hard chrome plated
5	Piston Rod B	Stainless steel	056 to 106
		Carbon steel	150 to 400, Hard chrome plated
6	Piston Rod C	Carbon steel	300 and 400 only
7	Collar	Aluminum alloy	Anodized
8	Snap ring	Carbon tool steel	Phosphate coated
9	Bushing	Phosphor bronze alloy	200 to 400
10	Rubber bumper	NBR	Use for with rubber bumper only
11	Stud	Steel alloy	Electroless nickel plated
12	Piston gasket	NBR	150 to 400
13	Piston seal	NBR	
14	Rod seal	NBR	
15	Tube gasket	NBR	
16	Gasket	NBR	300 and 400 only
17	Gasket	NBR	300 and 400 only
18	Super low head cap bolt	Carbon steel	300 and 400 only
19	Magnet	—	

Repair Parts: Standard Seal Kit for Double Acting, Double Rod

Bore size	Kit no.	Remarks
056(9/16")	NCQ8WB056-PS	Piston seal, rod seal and tube gasket are included.
075(3/4")	NCQ8WB075-PS	
106(1 1/16")	NCQ8WB106-PS	
150(1 1/2")	NCQ8WB150-PS	
200(2")	NCQ8WB200-PS	
250(2 1/2")	NCQ8WB250-PS	
300(3")	NCQ8WB300-PS	
400(4")	NCQ8WB400-PS	