



**SEW**  
**EURODRIVE**

# Operating Instructions



**MOVIMOT<sup>®</sup> MM..D**  
With DT/DV Series AC Motor



### 3.2.2 Sample inverter nameplate

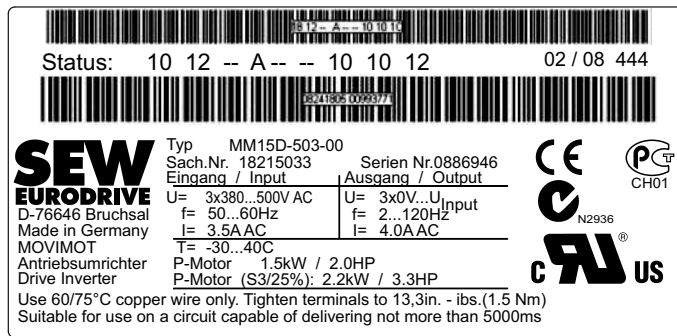

1957927307

#### MM 15 D – 503 – 00

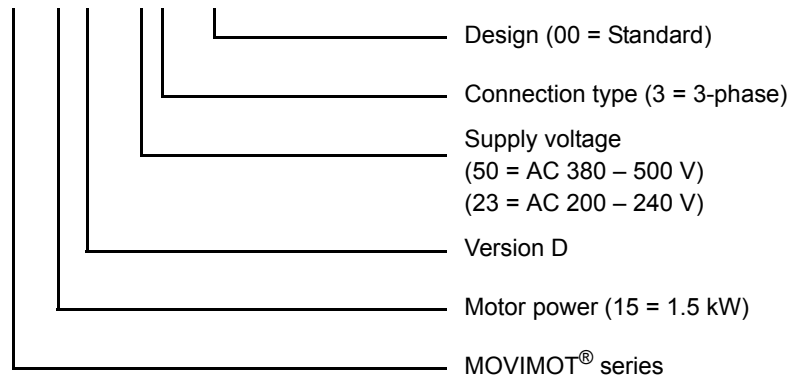

### 3.2.3 Unit identification

The unit identification [1] on the top of the MOVIMOT<sup>®</sup> inverter provides information about the inverter type [2], inverter part number [3], unit power [4].

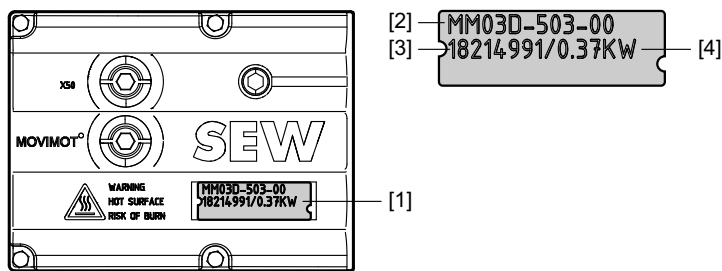

457916555



**3.2.4 "Mounting close to the motor" design**

The following illustration shows an example of the MOVIMOT® inverter mounted close to the motor with corresponding nameplate and unit designation:

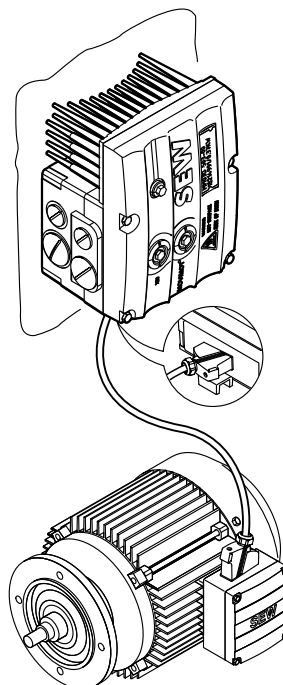

457921547

**MM15D-503-00/0/P21A/RO1A/APG4**

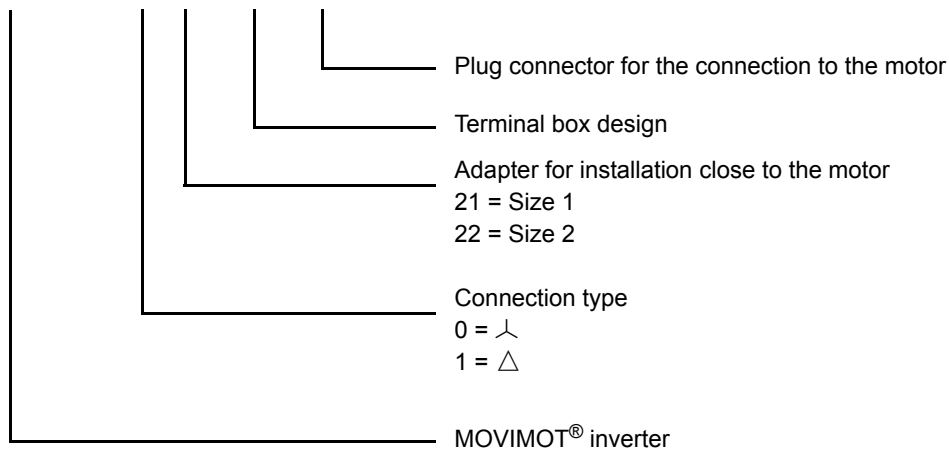



## Mechanical Installation

Installing the MOVIMOT<sup>®</sup> inverter close to the motor

### 4.7 Installing the MOVIMOT<sup>®</sup> inverter close to the motor

The following figure shows the mounting dimensions for installing the MOVIMOT<sup>®</sup> inverter close to the motor:

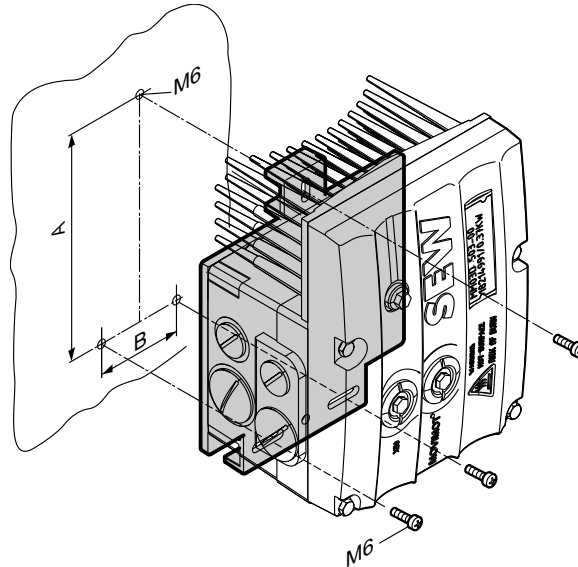

458277771

	A	B
MM03D503-00 – MM15D-503-00 MM03D233-00 – MM07D-233-00	140 mm	65 mm
MM22D503-00 – MM40D-503-00 MM11D233-00 – MM22D-233-00	170 mm	65 mm

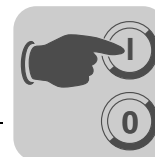

### 6.3.3 DIP switch S1/6

#### Lower motor power rating

- When activated, this DIP switch enables MOVIMOT® to be assigned to a motor with a lower power rating. The rated unit power is not affected.
- When a motor with a lower power rating is used, the overload capacity of the drive can be increased because, from the perspective of the motor, MOVIMOT® is one power rating too big. A higher current can be provided briefly, leading to higher torque ratings.
- The aim of this switch S1/6 is to achieve short-term utilization of the motor's peak torque. The unit's current limit remains the same regardless of the switch setting. The motor protection function is adjusted depending on the switch setting.
- Stall protection for the motor is not possible in this operating mode (S1/6 = "ON").

MOVIMOT® Inverter MM..D-503-00	Assigned motor 230/400 V, 50 Hz 266/460 V, 60 Hz			
	S1/6 = OFF		S1/6 = ON	
	⋈	△	⋈	△
380 – 500 V				
MM03D-503-00	DT71D4	DR63L4 <sup>1)</sup>	DR63L4 <sup>1)</sup>	–
MM05D-503-00	DT80K4	DT71D4	DT71D4	DFR63L4 <sup>1)</sup>
MM07D-503-00	DT80N4	DT80K4	DT80K4	DT71D4
MM11D-503-00	DT90S4	DT80N4	DT80N4	DT80K4
MM15D-503-00	DT90L4	DT90S4	DT90S4	DT80N4
MM22D-503-00	DV100M4	DT90L4	DT90L4	DT90S4
MM30D-503-00	DV100L4	DV100M4	DV100M4	DT90L4
MM40D-503-00	–	DV100L4	DV100L4	DV100M4

MOVIMOT® Inverter MM..D-233-00	Assigned motor 230/460 V, 60 Hz ⋈ / ⋈ / ⋈	
	S1/6 = OFF	S1/6 = ON
	⋈ ⋈	⋈ ⋈
200 – 240 V		
MM03D-233-00	DT71D4	DR63L4 <sup>1)</sup>
MM05D-233-00	DT80K4	DT71D4
MM07D-233-00	DT80N4	DT80K4
MM11D-233-00	DT90S4	DT80N4
MM15D-233-00	DT90L4	DT90S4
MM22D-233-00	DV100M4	DT90L4

1) Only possible with installation close to the motor



## 9.4 SEW Service

If a fault cannot be remedied, please contact SEW Service (see "Address List"). Please have the following information at hand when you consult the SEW Service:

- Service code [1]
- Unit designation on inverter nameplate [2]
- Part number [3]
- Serial number [4]
- Type designation on motor nameplate [5]
- Serial number [6]
- Short description of application (application, control via terminals or serial)
- Nature of the fault
- Accompanying circumstances (e.g. initial startup)
- Your own assumptions
- Any unusual events preceding the problem, etc.

[1]	Status: 10 12 -- A -- -- 10 10 12	02 / 08 444
[2]	<b>SEW EURODRIVE</b>	Typ MM15D-503-00
[3]	D-76646 Bruchsal Made in Germany MOVIMOT Antriebsumrichter Drive Inverter	Sach.Nr. 18215033 Eingang / Input U= 3x380...500V AC f= 50...60Hz I= 3.5AAC T= -30...40C P-Motor 1.5kW / 2.0HP P-Motor (S3/25%): 2.2kW / 3.3HP
		Serien Nr.0886946 Ausgang / Output U= 3x0V...U <sub>input</sub> f= 2...120Hz I= 4.0AAC
		CE CH01 N2936 C RU US
	Use 60/75°C copper wire only. Tighten terminals to 13,3in. - ibs.(1.5 Nm) Suitable for use on a circuit capable of delivering not more than 5000ms	

[5]	<b>SEW-EURODRIVE</b>	Bruchsal / Germany	CE
[6]	Typ KA77 DT90L4/BMG/MM15/MLU	3 ~ IEC 34	
	Nr. 3009818304.0001.99	IM B3	
	KW 1,5 / 50 HZ	cosφ 0,99	
	○ 50Hz V 380-500	A 3,50	○
	60Hz V 380-500	A 3,50	
	r/min 22/1400	IP 54 KI F	
	Bremse V 230	Nm 20 Gleichrichter	
	kg 73 Ma 665	Nm i 64,75 :1	
	Schmierstoff	Made in Germany 184103 3.14	

2037711371

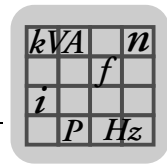

### 10.9 Assignment of internal braking resistors

MOVIMOT® type	Braking resistor	Part number
MM03D-503-00 – MM15D-503-00 MM03D-233-00 – MM07D-233-00	BW1	0 822 897 3 <sup>1)</sup>
MM22D-503-00 – MM40D-503-00 MM11D-233-00 – MM22D-233-00	BW2	0 823 136 2 <sup>1)</sup>

1) Two screws M4 x 8, included in scope of delivery

### 10.10 Assignment of external braking resistors

MOVIMOT® type	Braking resistor	Part number	Protective grid
MM03D-503-00 – MM15D-503-00 MM03D-233-00 – MM07D-233-00	BW200-003/K-1.5	0 828 291 9	0 813 152 X
	BW200-005/K-1.5	0 828 283 8	–
	BW150-010	0 802 285 2	–
MM22D-503-00 – MM40D-503-00 MM11D-233-00 – MM22D-233-00	BW100-003/K-1.5	0 828 293 5	0 813 152 X
	BW100-005/K-1.5	0 828 286 2	–
	BW068-010	0 802 287 9	–
	BW068-020	0 802 286 0	–

#### 10.10.1 BW100.. BW200..

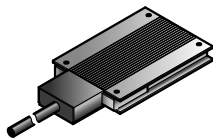

	BW100-003/ K -1.5	BW100-005/ K -1.5	BW200-003/ K -1.5	BW200-005/ K -1.5
Part number	0 828 293 5	0 828 286 2	0 828 291 9	0 828 283 8
Function	Dissipating the regenerative energy			
Degree of protection	IP65			
Resistance	100 Ω	100 Ω	200 Ω	200 Ω
Power in S1, 100% cdf	100 W	200 W	100 W	200 W
Dimensions W x H x D mm	146 x 15 x 80	252 x 15 x 80	146 x 15 x 80	252 x 15 x 80
Cable length	1.5 m			

#### 10.10.2 BW150.. BW068..

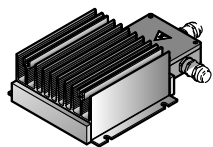

	BW150-010	BW068-010	BW068-020
Part number	0 802 285 2	0 802 287 9	0 802 286 0
Function	Dissipating the regenerative energy		
Degree of protection	IP66		
Resistance	150 Ω	68 Ω	68 Ω
Power according to UL in S1, 100% cdf	600 W	600 W	1200 W
Power according to CE in S1, 100% cdf	900 W	900 W	1800 W
Dimensions W x H x D mm	260 x 75 x 174	260 x 75 x 174	610 x 75 x 174
Maximum permitted cable length	15 m		