

Gear motor GT 50

Technical Information · GB

3 Edition 11.14



- Controlled by three-point step signal:
GT 50..E by continuous signal,
GT 50..R by two-point step signal
- Simple commissioning thanks to Automatic/Manual mode changeover
- Position indicator that can be read externally
- Precise setting of the switching positions thanks to infinitely adjustable switching cams
- Installation options for two control elements
- Spacious connection chamber for ease of installation
- Any installation position
- Low-maintenance operation



7 Technical data

Mains voltage:

220/240 V AC, -15/+10%, 50/60 Hz,

110/120 V AC, -15/+10%, 50/60 Hz,

24 V AC, -15/+10%, 50/60 Hz.

Power consumption, running time and torque:

Type	Power consumption [VA] at		Running time* for rotary movement [s]		Torque** [Nm]
	50 Hz	60 Hz	0–90°	0–160°	
GT 50-03	11	13.3	3.7	–	3.7
GT 50-07	11	13.3	7.5	–	7.5
GT 50-15	11	13.3	15	–	15
GT 50-30	11	13.3	30	–	20
GT 50-60	4.8	5.8	60	–	20
GT 50-120	4.8	5.8	120	–	20
GT 50-06	4.8	5.8	–	6.5	3.7
GT 50-13	4.8	5.8	–	13	7.5
GT 50-27	4.8	5.8	–	27	15
GT 50-54	4.8	5.8	–	54	20
GT 50-107	4.8	5.8	–	107	20
GT 50-214	4.8	5.8	–	214	20

* At 50 Hz. The running time drops to approx. 83% at 60 Hz.

** When driving two shafts, the torques of the individual shafts must be added together.

Screw terminals for cables up to 4 mm² (single core cables) and for cables up to 2.5 mm² with wire end ferrules.

Angle of rotation:

GT 50-03 to GT 50-120: 0–90°, adjustable,

GT 50-06 to GT 50-214: 0–160°, adjustable.

Holding torque = torque.

Electrical connection:

line entrance via 2 × PG 13.5 plastic cable glands.

Switching capacity of the position switches:

Voltage	Resistive load	Incandescent lamp load	Inductive load
125 V AC	2 A	0.5 A	2 A
250 V AC	2 A	0.5 A	2 A
< 30 V DC	2 A	2 A	2 A
< 50 V DC	1 A	0.4 A	1 A
< 75 V DC	0.75 A	0.3 A	0.75 A
< 125 V DC	0.5 A	0.2 A	0.03 A
< 250 V DC	0.25 A	0.1 A	0.03 A
12–30 V AC/DC	10–100 mA	–	10–100 mA

Enclosure: IP 54 pursuant to IEC 529.

Safety class: I pursuant to EN 60335.

Ambient and storage temperature: -20 to +60°C, no condensation permitted.

Weight: 2.6 kg.

Direction of rotation

Anti-clockwise from 0 to 90°.

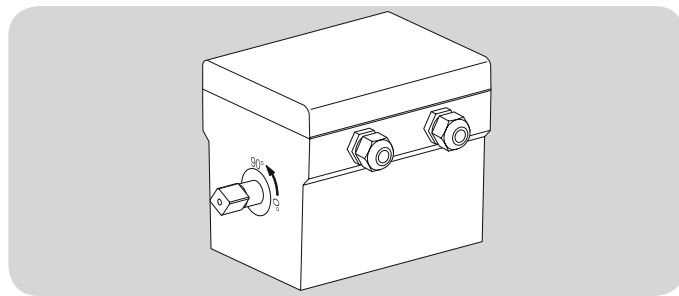

GT 50..E

Power consumption:

6.3 VA at 50 Hz, 7.3 VA at 60 Hz.

Feedback output:

max. 500 Ω load impedance.

Input:

4 (0)–20 mA: 50 Ω load impedance,

0–10 V: 150 k Ω input resistance.

7.1 Dimensions

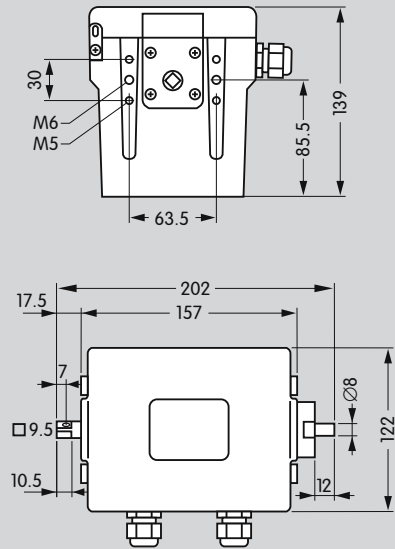

8 Maintenance cycles

Gear motor GT 50 suffers little wear and requires little servicing.

We recommend a function check once a year.