

# LG contactors, 3-pole Contactors, GMC contactor

Part number of LG GMC contactors: GMC-9,GMC-12,GMC-148,GMC-22, GMC-32,



GMC-40, GMC-50, GMC-65, GMC-75, GMC-85, GMC-100,GMC-125,GMC-150,GMC-180,GMC-

220, GMC-300,GMC-400,GMC-600,GMC-800,

GMD-9,GMD-12,GMD-148,GMD-22,GMD-32,GMD-40,GMD-50,GMD-65,GMD-75,GMD-85

Frame size		9A		12A		18A		22A	
<b>3-pole Contactors</b>		 <i>includes AU-1 auxiliary switch, (1 N.O. / 1 N.C.)</i>							
Types	AC coil	GMC-9		GMC-12		GMC-18		GMC-22	
	DC coil	GMD-9		GMD-12		GMD-18		GMD-22	
<b>Ratings / IEC60947-4</b>		kW	A	kW	A	kW	A	kW	A
AC1		<b>25</b>		<b>25</b>		<b>40</b>		<b>40</b>	
AC3	200/240V	2.5	11	3.5	13	4.5	18	5.5	22
	<b>380/440V</b>	<b>4</b>	<b>9</b>	<b>5.5</b>	<b>12</b>	<b>7.5</b>	<b>18</b>	<b>11</b>	<b>22</b>
	500/550V	4	7	7.5	12	7.5	13	15	22
	690V	4	5	7.5	9	7.5	9	15	18
<b>Ratings / UL508</b>		hp	A	hp	A	hp	A	hp	A
continuous current		20		25		30		32	
single phase	115V	0.5		0.5		1		2	
	230V	1		2		3		3	
three phase	200V	2		3		5		7	
	230V	2		3		5		7.5	
	<b>460V</b>	<b>5</b>		<b>7.5</b>		<b>10</b>		<b>10</b>	
	575V	7.5		10		15		15	
NEMA size		00		00		0		0	

**4-pole Contactors**  
*For further technical information visit [altechcorp.com](http://altechcorp.com).*

Types	AC coil	GMC-9/4	GMC-12/4	GMC-18/4	GMC-22/4
	DC coil	GMD-9/4	GMD-12/4	GMD-18/4	GMD-22/4
AC1(A)		<b>20</b>	<b>20</b>	<b>25</b>	<b>32</b>

**Available coil voltages**  
 AC: 24, 42, 48, 110, 120, 208, 220, 240, 277, 380, 440, 480, 600V  
 DC: 12, 20, 24, 48, 60, 80, 100, 110, 125, 200, 220, 250V  
*Ordering Example: GMC-9-AC120V (see also page 6)*

**Additional Auxiliary Contacts**



**AU-2**  
2-pole  
Front mount





**AU-4**  
4-pole  
Front mount





**AU-1**  
2-pole  
Side mount



Configuration	Part No.	Configuration	Part No.	Configuration	Part No.
2 N.O.	<a href="#">AU-2-20</a>	4 N.O.	<a href="#">AU-4-40</a>	1 N.O. / 1 N.C.	<a href="#">AU-1</a>
2 N.C.	<a href="#">AU-2-02</a>	3 N.O. / 1 N.C.	<a href="#">AU-4-31</a>		
1 N.O. / 1 N.C.	<a href="#">AU-2-11</a>	2 N.O. / 2 N.C.	<a href="#">AU-4-22</a>		
		1 N.O. / 3 N.C.	<a href="#">AU-4-13</a>		
		4 N.C.	<a href="#">AU-4-04</a>		

**Overload Relays**



<b>Bimetallic style Type GT</b>		 <p><b>GT-22</b></p>	<p>Setting ranges (A)</p> <table border="0"> <tr><td>0.1 - 0.16</td><td>4 - 6</td></tr> <tr><td>0.16 - 0.25</td><td>5 - 8</td></tr> <tr><td>0.25 - 0.4</td><td>6 - 9</td></tr> <tr><td>0.4 - 0.63</td><td>7 - 10</td></tr> <tr><td>0.63 - 1</td><td>9 - 13</td></tr> <tr><td>1 - 1.6</td><td>12 - 16</td></tr> <tr><td>1.6 - 2.5</td><td>16 - 22</td></tr> <tr><td>2.5 - 4</td><td></td></tr> </table>	0.1 - 0.16	4 - 6	0.16 - 0.25	5 - 8	0.25 - 0.4	6 - 9	0.4 - 0.63	7 - 10	0.63 - 1	9 - 13	1 - 1.6	12 - 16	1.6 - 2.5	16 - 22	2.5 - 4		 <p><b>AZ-22H</b> <i>Base for separate mounting</i></p>
0.1 - 0.16	4 - 6																			
0.16 - 0.25	5 - 8																			
0.25 - 0.4	6 - 9																			
0.4 - 0.63	7 - 10																			
0.63 - 1	9 - 13																			
1 - 1.6	12 - 16																			
1.6 - 2.5	16 - 22																			
2.5 - 4																				
Class 10A	Differential	<a href="#">GTK-22</a>																		
	Non-differential (3-heater)	<a href="#">GTH-22/3</a>																		
	Non-differential (2-heater)	<a href="#">GTH-22</a>																		
Class 20	Differential	<a href="#">GTK-22/L</a>																		





# Contactors (9 to 85A)

32A		40A		50A		65A		75A		85A	
		<i>includes 2 AU-1 auxiliary switches, (2 N.O. / 2 N.C.)</i>				<i>includes 2 AU-1 auxiliary switches, (2 N.O. / 2 N.C.)</i>					
GMC-32		GMC-40		GMC-50		GMC-65		GMC-75		GMC-85	
GMD-32		GMD-40		GMD-50		GMD-65		GMD-75		GMD-85	
kW	A	kW	A	kW	A	kW	A	kW	A	kW	A
	<b>50</b>		<b>60</b>		<b>80</b>		<b>100</b>		<b>110</b>		<b>135</b>
7.5	32	11	40	15	55	18.5	65	22	75	25	85
<b>15</b>	<b>32</b>	<b>18.5</b>	<b>40</b>	<b>22</b>	<b>50</b>	<b>30</b>	<b>65</b>	<b>37</b>	<b>75</b>	<b>45</b>	<b>85</b>
18.5	28	22	32	30	43	33	60	37	64	45	75
18.5	20	22	23	30	28	33	35	37	42	45	45
hp	A	hp	A	hp	A	hp	A	hp	A	hp	A
	45		50		70		80		90		100
2		3		3		5		5		7.5	
5		5		7.5		10		15		15	
7.5		10		10		15		20		25	
10		10		15		20		25		30	
<b>20</b>		<b>25</b>		<b>30</b>		<b>40</b>		<b>50</b>		<b>50</b>	
20		25		30		40		50		50	
1		1		2		2		2		3	

											
GMC-32/4		GMC-40/4		GMC-50/4		GMC-65/4		GMC-75/4		GMC-85/4	
GMD-32/4		GMD-40/4		GMD-50/4		GMD-65/4		GMD-75/4		GMD-85/4	
<b>50</b>		<b>60</b>		<b>80</b>		<b>100</b>		<b>110</b>		<b>135</b>	

AC: 24, 48, 110, 120, 208, 220, 240, 277, 380, 440, 480, 600V  
 DC: 12, 20, 24, 48, 60, 80, 100, 110, 125, 200, 220, 250V  
*Ordering Example: GMC-32-AC120V (see also page 6)*

					
Configuration	Part No.	Configuration	Part No.	Configuration	Part No.
2 N.O.	AU-2-20	4 N.O.	AU-4-40	1 N.O. / 1 N.C.	AU-1
2 N.C.	AU-2-02	3 N.O. / 1 N.C.	AU-4-31		
1 N.O. / 1 N.C.	AU-2-11	2 N.O. / 2 N.C.	AU-4-22		
		1 N.O. / 3 N.C.	AU-4-13		
		4 N.C.	AU-4-04		

							
Setting ranges (A)		Setting ranges (A)		Setting ranges (A)		Setting ranges (A)	
4 - 6	12 - 18	7 - 10	28 - 40	9 - 13	34 - 50		
5 - 8	16 - 22	12 - 18	45 - 65	16 - 22	54 - 75		
6 - 9	18 - 26	18 - 26	63 - 85	24 - 36			
7 - 10	24 - 36						
9 - 13	28 - 40						
<b>GTK-40</b>	<b>AZ-40H</b>	<b>GTK-85</b>	<b>AZ-85H</b>				
GTH-40/3		GTH-85/3					
GTH-40		GTH-85					
GTK-40/L		GTK-85/L					

# 3-pole Contactors / AC Coil

(Dimensions shown in mm, to convert to inches multiply by 0.03937)

- GMC-9
- GMC-12
- GMC-18
- GMC-22

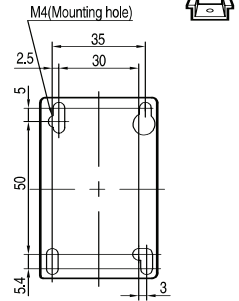
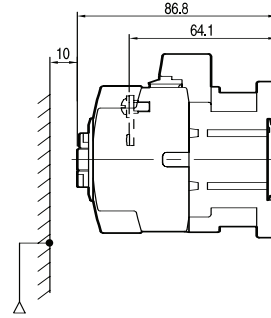
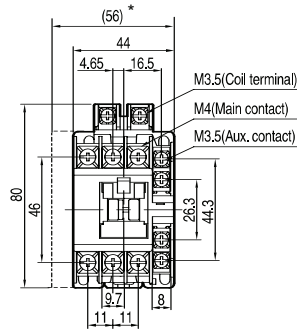

\*Optional auxiliary contact unit (side mount type)

Weight: GMC-9 & 12: 0.33kg (0.73 lbs.)  
GMC-18 & 22: 0.37kg (0.82 lbs.)

- GMC-32
- GMC-40

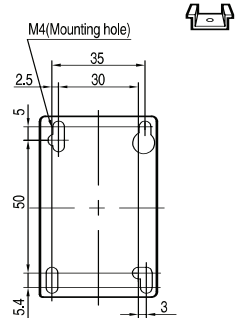
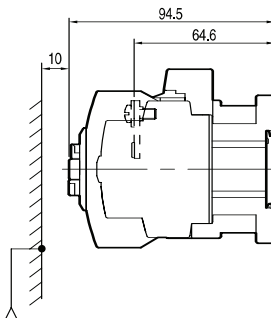
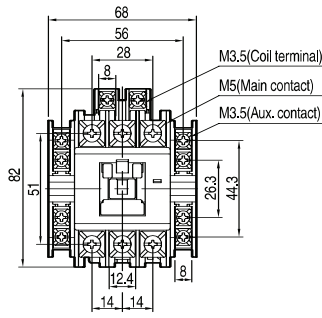

Weight GMC-32 & 40: 0.45kg (0.99 lbs.)

- GMC-50
- GMC-65
- GMC-75
- GMC-85

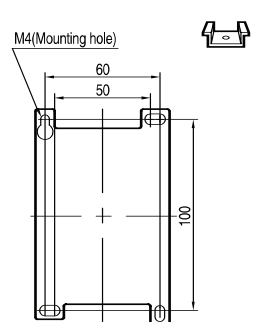
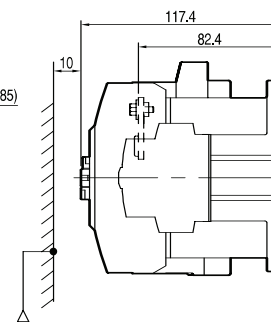
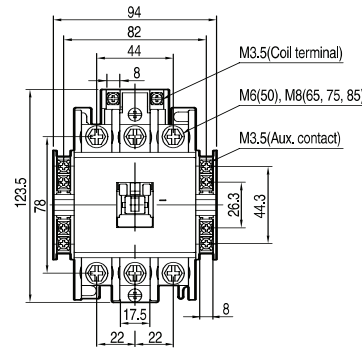

Weight: GMC-50 to 85: 1kg (2.21 lbs.)

GMC-9~22

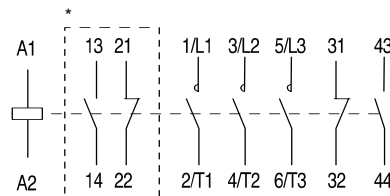

GMC-32~85

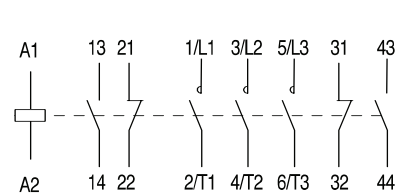

\*Optional auxiliary contact unit