

Series CST-CSV-CSH, CSB-CSC-CSD, CSG magnetic proximity switches

Reed

Magneto-resistive - Hall effect (Series CST, CSV, CSH only)



- » Series CST, CSV, CSH, CSG switches: integrated in the actuator profile, with or without M8 connector and new ATEX version
- » Series CSB switches: for grippers CGA, CGP
- » Series CSC switches: for grippers CGLN
- » Series CSD switches: for grippers CGSN, CGPT, CGPS, RPGB, CGCN, CGZT
- » Series CSG switches: ATEX and UL certified

The magnetic proximity switches define the position of the piston in cylinders or grippers. When the internal contact is actuated by a magnetic field, the sensors complete an electrical circuit and provide an output signal to actuate directly a solenoid valve or a PLC. A yellow or red LED diode shows when the internal magnetic contact is closed.

The switches are available in two different versions - Reed with mechanical switching and with electronic switching - and they are subdivided into Hall effect and Magneto-resistive. The electronic versions are suggested for heavy duty with frequent operations and strong vibrations.

Magnetic proximity switches with 2- or 3-wire cable for T-slot



Note for 2-wire switches Mod. CST-220, CST-220-5:
in case of polarity reversing the sensor will still be operating, but the LED diode won't turn on.

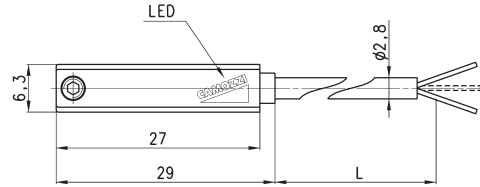
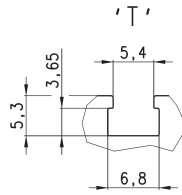

Mod.	Operation	Connections	Voltage	Output	Max. current	Max Load	Protection	L = length cable
CST-220	Reed	2 wires	10 ÷ 110 V AC/DC-230 V AC	-	250 mA	10 VA / 8W	None	2 m
CST-220-5	Reed	2 wires	10 ÷ 110 V AC/DC-230 V AC	-	250 mA	10 VA / 8 W	None	5 m
CST-220-12	Reed	2 wires	10 ÷ 110 V AC/DC-230 V AC	-	250 mA	10 VA / 8W	None	12 m
CST-220EX	Reed	2 wires	10 ÷ 110 V AC/DC-230 V AC	-	250 mA	10 VA / 8W	None	2 m
CST-220-5EX	Reed	2 wires	10 ÷ 110 V AC/DC-230 V AC	-	250 mA	10 VA / 8W	None	5 m
CST-220-12EX	Reed	2 wires	10 ÷ 110 V AC/DC-230 V AC	-	250 mA	10 VA / 8W	None	12 m
CST-232	Reed	3 wires	5 ÷ 30 V AC/DC	PNP	250 mA	10 VA / 8 W	Against polarity reversing	2 m
CST-232-5	Reed	3 wires	5 ÷ 30 V AC/DC	PNP	250 mA	10 VA / 8 W	Against polarity reversing	5 m
CST-232EX	Reed	3 wires	5 ÷ 30 V AC/DC	PNP	250 mA	10 VA / 8W	Against polarity reversing	2 m
CST-232-5EX	Reed	3 wires	5 ÷ 30 V AC/DC	PNP	250 mA	10 VA / 8W	Against polarity reversing and overvoltage	5 m
CST-332	Magneto resistive	3 wires	10 ÷ 27 V DC	PNP	100 mA	6 W	Against polarity reversing and overvoltage	2 m

Magnetic proximity switches with 2- or 3-wire cable for V-slot



Note for 2-wire switch Mod. CSV-220:
In case of polarity reversing the sensor will still be operating, but the LED diode won't turn on.

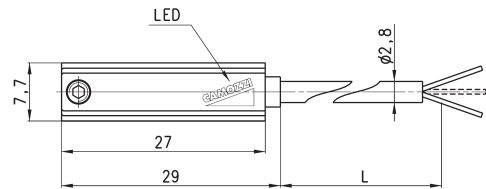
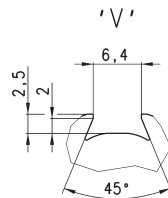

Mod.	Operation	Connections	Voltage	Output	Max. current	Max Load	Protection	L = length cable
CSV-220	Reed	2 wires	10 ÷ 110 V AC/DC-230 V AC	-	250 mA	10 VA / 8 W	None	2 m
CSV-232	Reed	3 wires	5 ÷ 30 V AC/DC	PNP	250 mA	10 VA / 8W	Against polarity reversing	2 m
CSV-332	Magneto resistive	3 wires	10 ÷ 27 V DC	PNP	100 mA	6 W	Against polarity reversing and overvoltage	2 m

Load curves of sensors Mod. CSH, CST, CSV

CSH-223, CSH-253, CSH-233, CSH-263, CSH-463

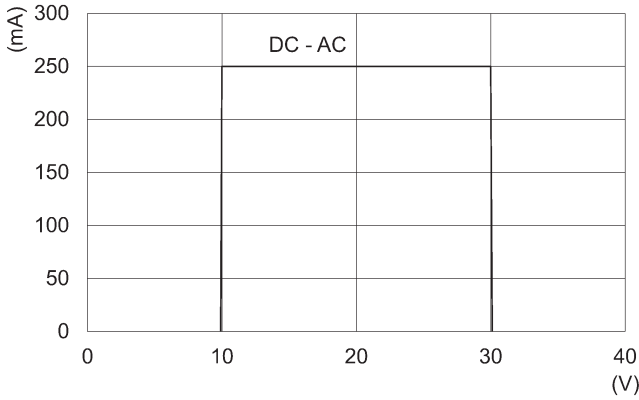

CSH-334, CSH-364

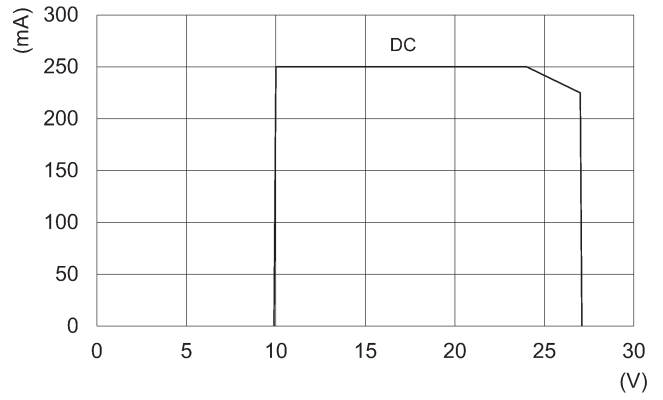

CST-250N, CSV-250N

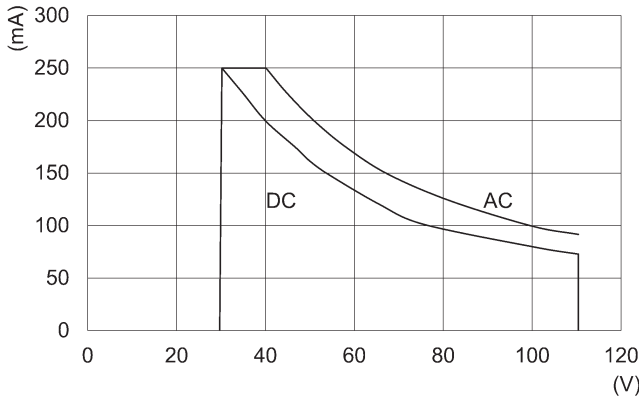

CST-232, CSV-232, CST-262, CSV-262

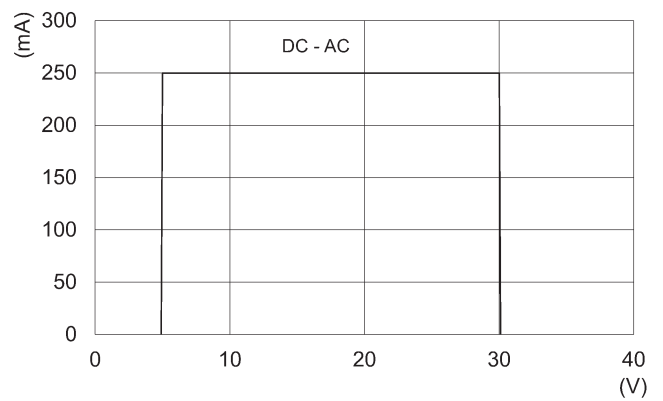

CST-332, CSV-332, CST-362, CSV-362, CST-532, CSV-562

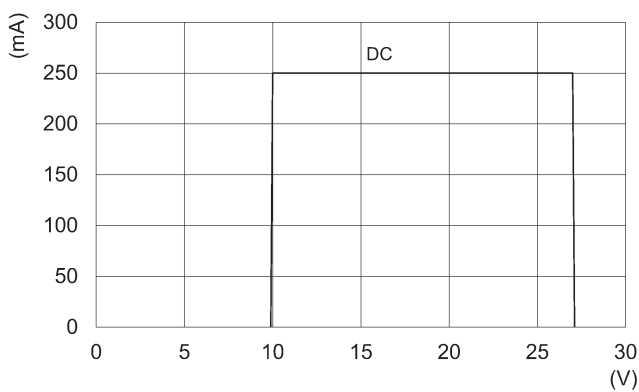

CSH-221, CST-220, CSV-220

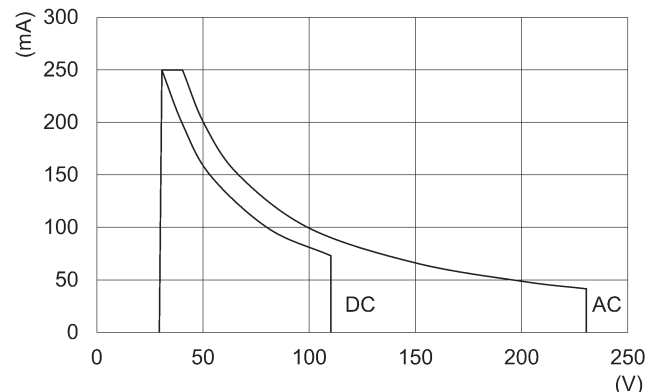

SERIES CST-CSV-CSH-CSB-CSC-CSD-CSG SENSORS