

## ACTUATOR AZM 161-B1ES

- Straight actuator
- Particularly suitable for sliding doors

### Data

#### Ordering data

Product type description	ACTUATOR AZM 161-B1ES
Article number (order number)	101171859
EAN (European Article Number)	4030661299600
eCl@ss number, version 12.0	27-27-26-06
eCl@ss number, version 11.0	27-27-26-06
eCl@ss number, version 9.0	27-27-26-06
ETIM number, version 7.0	EC001487
ETIM number, version 6.0	EC001487

#### General data

Material of the actuator	Stainless steel (V2A)
Gross weight	30 g

#### Mechanical data

Actuator	straight
Actuating play in direction of actuation	2 mm

#### Note

Note (General)

minimum actuating radius on hinged guards in line with the plane of the actuator 150 mm

minimum actuating radius on rotating guard systems via the narrow edge of the actuator 180 mm

## Pictures

### Product picture (catalogue individual photo)



ID: kazm1f44

| 7.3 MB | .tif | 195.4 x 130.2 mm - 1954 x 1302 px - 254 dpi

| 183.2 kB | .jpg | 352.778 x 235.303 mm - 1000 x 667 px - 72 dpi

| 16.3 kB | .png | 74.083 x 49.389 mm - 210 x 140 px - 72 dpi

### Dimensional drawing actuator

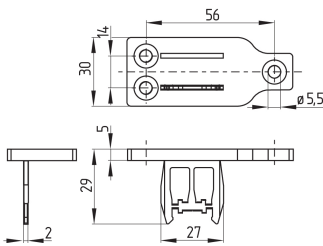

ID: lazmb25

| 97.2 kB | .jpg | 352.778 x 260.703 mm - 1000 x 739 px - 72 dpi

| 11.4 kB | .png | 74.083 x 54.681 mm - 210 x 155 px - 72 dpi

K.A. Schmersal GmbH & Co. KG, Möddinghofe 30, 42279 Wuppertal

The details and data referred to have been carefully checked. Images may diverge from original. Further technical data can be found in the manual. Technical amendments and errors possible.

Generated on: 31/07/2023, 16:05