

AC5000

ASI-MODUL-UNTERTEIL FK

Bus system AS-Interface

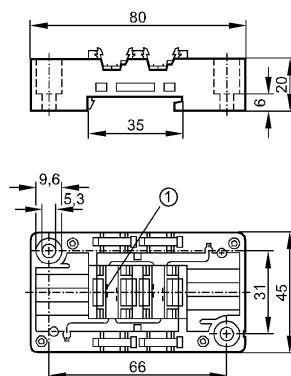

1: contact pins



Product characteristics

Module lower part flat cable

Mounting on DIN rail and panel

Quick mounting technology for AS-i flat cable

AS-i interface to module upper part

Electrical data

Electrical design FC coupling module

Operating voltage [V] 26.5...31.6 DC

Environment

Ambient temperature [°C] -25...85

Protection IP 67; IP 20 / IP 65 / IP 67 depending on the upper part used

Mechanical data

Housing materials PBT (Pocan)

Weight [kg] 0.059

Electrical connection

Connection via contact pins in the unit

Contact rating < 2 A

Remarks

Pack quantity [piece] 1