

Specialty Push Button Specifications

Bulletin 800K, 800L, 800P, 800T, 800Z

Topic	Page
Summary of Changes	2
Bulletin 800P Palm-Operated Push Buttons	3
Bulletin 800Z Zero-Force Touch Buttons™	6
Bulletin 800T 18 mm Small Pilot Light Type 4/13, Class I, Division 2	13
Bulletin 800K Piezo Operators	15
Bulletin 800L — 12, 18, 22, and 30 mm Indicators	18



Bulletin 800P Palm-Operated Push Buttons



Palm-Operated Flush Mount Button
Cat. No. 800P-F2CA



Palm-Operated Surface Mount with Guard
Cat. No. 800P-S2CG1A

800P – **S** **1** **C** **G** **1** **A**
a b c d e f

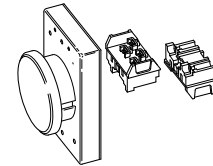

a	
Operator Type	
Code	Description
F	Flush mount
S	Surface mount

b	
Button Operation	
Code	Description
1	Standard drive
2	Articulated

c	
Button Color	
Code	Description
C	Chrome
R	Red (painted)
Y	Yellow (painted)

d	
Guard Option	
Code	Description
Blank	No guard
G	Side guard (yellow)
H	Die cast (gray)

e	
Enclosure Openings	
Code	Description
Blank	No base ❶
1	Single hub
2	Double hub

f	
Contact Block	
Standard	
Code	Description
A	1 N.O. - 1 N.C.
B	2 N.O. - 2 N.C.
PenTUFF™ (Low Voltage)	
AV	1 N.O. - 1 N.C.
BV	2 N.O. - 2 N.C.

❶ Only used for flush mounted operators.

Specifications ❷

Electrical Ratings

Attribute	Description
Dielectric Strength	2200V for 1 minute
Electrical Design Lifecycles	1,000,000 at maximum rated load 200,000 at maximum rated load (Logic Reed)

Mechanical Ratings

Attribute	Description	
Vibration	10...2000 Hz 1.52 mm displacement (peak-to-peak) 10 G max.	
Shock	Mechanical shock at 1/2 cycle sine-wave for 11 ms	
Contact Fragility ❸	25 G	800T-XA1, -XA2, -XD1, -XD4, -XD2R, contact blocks
	9 G	800T-XA, -XA4, -XD2, -XD3, -XAR, -XAV contact blocks
	6 G	800T-XD1R
Degree of Protection	Type 1, 12, 4/13; watertight/oiltight 529 IP65	
Mechanical Design Lifecycles	Push Buttons	1,000,000 minimum
Contact Operation	Shallow Contact Block	Slow, double make and break
	Logic Reed	Snap action
Typical Operating Forces	Articulated	800T-XD1 and 800T-XD4 contact blocks 3.7 lb maximum at center of button, 2.7 lb at perimeter
	Standard Drive	3.7 lb

❷ **Performance Data** — Performance data that is given in this publication is provided only as a guide for you to determine suitability and does not constitute a performance warranty of any kind. Such data represents the results of accelerated testing at elevated stress levels, and you are responsible for correlating the data to actual application requirements. ALL WARRANTIES AS TO ACTUAL PERFORMANCE, WHETHER EXPRESS OR IMPLIED, ARE EXPRESSLY DISCLAIMED.

❸ No damage at 100 G all contact blocks.

Environmental

Attribute	Description	
Temperature Range	Operating	32...131 °F (0...55 °C)
	Storage	-40...+185 °F (-40...+85 °C)

Standard Contact Ratings

(IEC 947-5-1) (NEMA ICS 2-125) Maximum continuous current I_{th} 10 A. Bulletin 800P units have control circuit ratings with catalog number 800T-XA1, -XD1, -XD4, -XA2, -XA, -XA4, -XD2, and -XD3 contact blocks as follows:

Maximum Operational Volts U_e	Utilization Category		Rated Operational Currents		
	IEC	NEMA	Volts U_e	Make → □ ←	Break ← □ →
AC 600	AC-15	A600	120...600	7200VA	720VA
			72...120	60 A	720VA
			24...72	60 A	10 A
DC 60	DC-13	Q600	28...600	69VA	
			24...28	2.5 A	

PenTUFF™ (Low Voltage) Contact Ratings

Minimum DC: 5V, 1 mA. Maximum thermal continuous current I_{th} 2.5 A AC/1.0 A DC. Bulletin 800P units with catalog number 800T-XAV contacts have ratings as follows:

Maximum Operational Volts U_e	Utilization Category		Rated Operational Currents		
	IEC	NEMA	Volts U_e	Make → □ ←	Break ← □ →
AC 300	AC-15	C300	120...300	1800VA	180VA
			0...120	15 A	1.5 A
DC 150	DC-13	R150	24...150	28VA	
			0...24	1.0 A	

Approximate Dimensions

Dimensions in inches (millimeters). Dimensions are not intended to be used for manufacturing purposes.

Legend Plate Dimensions (Bulletin 800T 18 mm Pilot Lights Only)

Legend Plate for Small Pilot Light — Type A Legend

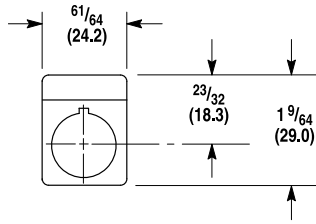

Cat. No. 800T-N515

Legend Plate for Small Pilot Light — Type B Legend

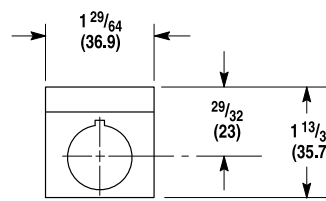

Cat. No. 800T-N516
(Automotive Industry Type)

18 mm Small Pilot Lights

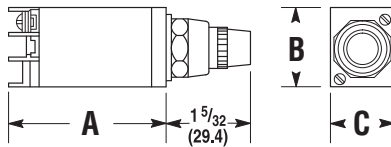

Small Pilot Light Including Push-to-test
Shipping Weight 3 oz (0.08 kg)

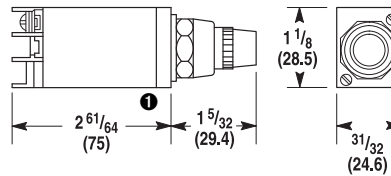

Small Pilot Light Dual Input (Diode)
Shipping Weight 3 oz (0.08 kg)

❶ Transfer dual-input pilot light dimension is 2-31/32 in. (75.4 mm).

Device	A	B	C
800T-PS, -PSD, -PST, -QS, -QST, and -RST	2-1/4 (57.2)	1-1/16 (27)	27/32 (21.4)
800T-PSDT	2-61/64 (75)	1-15/64 (31.4)	31/32 (24.6)