

Dimensions in inches (millimeters). Dimensions are not intended to be used for manufacturing purposes.

Push Buttons and Switches (Bul. 800T Only)

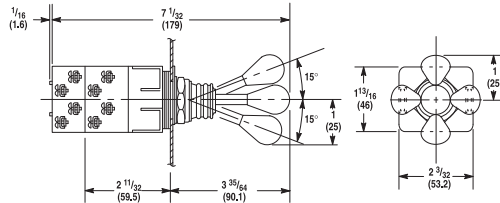

2-3-4 Way Switch
 Shipping Wt. with 2 Contact Blocks 6 oz (0.17 kg)
 Shipping Wt. with 4 Contact Blocks 8-1/2 oz (0.24 kg)

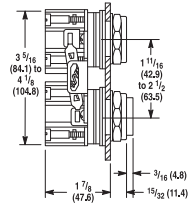

Mechanically Interlocked
 Maintained Contact Push Button
 Shipping Wt. 1 lb (0.45 kg)

Push Buttons and Pilot Lights

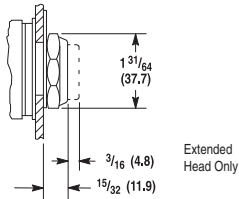

Flush and Extended
 Head Push Button
 Shipping Wt. 5-1/2 oz (0.15 kg)

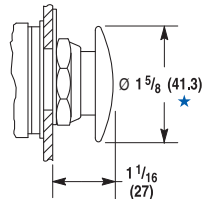

Mushroom Head Push Button
 Shipping Wt. 7-1/2 oz (0.21 kg)

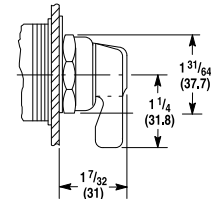

Non-Illuminated Knob Lever and
 Standard Knob Selector Switch
 Shipping Wt. 6 oz (0.17 kg)

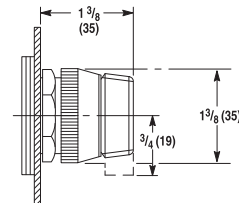

Illuminated Knob Lever and
 Standard Knob Selector Switch
 Shipping Wt. 6 oz (0.17 kg)

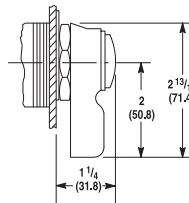

Wing Lever Selector Switch
 Shipping Wt. 8 oz (0.22 kg)

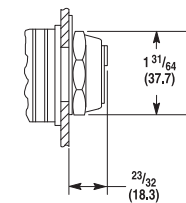

Coin Slot Selector Switch
 Shipping Wt. 6 oz (0.17 kg)

★ Except jumbo which is 2-1/4 (57.2).

Operator Extension in Front of Panel (Bul. 800T Only)

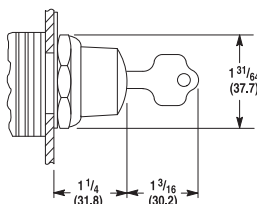

Key Operated Selector Switch
 Shipping Wt. 12 oz (0.34 kg)

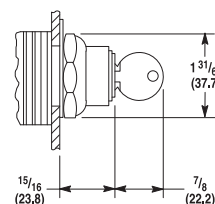

Push Button with Cylinder Lock
 Shipping Wt. 12 oz (0.34 kg)

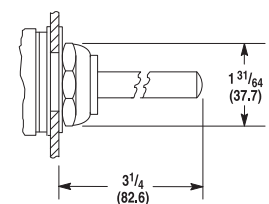

Wobble Stick
 Shipping Wt. 9 oz (0.25 kg)

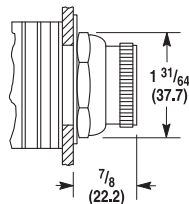

Selector Push Button
 Shipping Wt. 6 oz (0.17 kg)

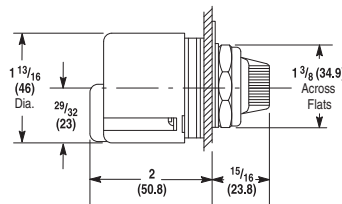

Type J Potentiometer Unit
 Shipping Wt. 4 oz (0.11 kg)

