

Load feeder fuseless direct-on-line starting, 400 V AC Size S0 11-16 A, 24 V DC Screw terminal on 60 mm busbar adapter Type of coordination 2, Iq = 50 kA (also fulfills type of coordination 1) !!! Phased-out product !!! Successor is SIRIUS 3RA2 Preferred successor type is >>3RA2120-4AD26-0BB4<<

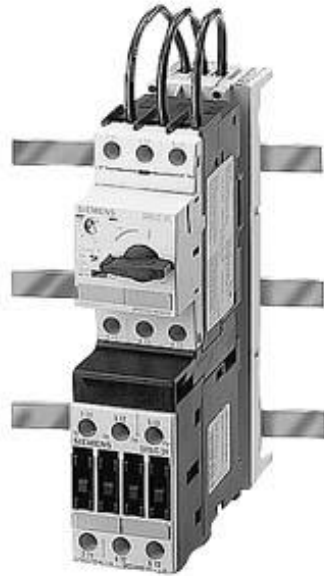

Figure similar

<b>Product brand name</b>	SIRIUS
<b>Product designation</b>	non-fused load feeder
<b>Design of the product</b>	direct starter
<b>Manufacturer's article number</b>	
<ul style="list-style-type: none"> <li>• of the supplied contactor</li> <li>• of the supplied circuit-breakers</li> <li>• of the supplied busbar adapter</li> <li>• of the supplied link module</li> </ul>	<ul style="list-style-type: none"> <li><a href="#">3RT1026-1BB40</a></li> <li><a href="#">3RV1021-4AA10</a></li> <li><a href="#">8US1251-5DM07</a></li> <li><a href="#">3RA1921-1BA00</a></li> </ul>

General technical data	
<b>Size of load feeder</b>	S0
<b>Product extension</b>	
<ul style="list-style-type: none"> <li>• Auxiliary switch</li> </ul>	Yes
<b>Insulation voltage</b>	
<ul style="list-style-type: none"> <li>• rated value</li> </ul>	690 V
<b>Degree of pollution</b>	3
<b>Surge voltage resistance rated value</b>	6 kV
<b>Protection class IP</b>	

• on the front	IP20
<b>Shock resistance</b>	12.5g
<b>Mechanical service life (switching cycles)</b>	
• of contactor typical	10 000 000
<b>Type of assignment</b>	2
• (certificate of suitability)	UL / CSA / CCC / GL / LRS / BV / DNV / PRS
<b>Reference code acc. to DIN 40719 extended according to IEC 204-2 acc. to IEC 750</b>	Q
<b>Reference code acc. to DIN EN 81346-2</b>	Q
<b>Reference code acc. to DIN EN 61346-2</b>	Q

#### Ambient conditions

<b>Installation altitude at height above sea level</b>	
• maximum	2 000 m

#### Main circuit

<b>Number of poles for main current circuit</b>	3
<b>Design of the switching contact</b>	electromechanical
<b>Adjustable pick-up value current of the current-dependent overload release</b>	11 ... 16 A
<b>Type of the motor protection</b>	bimetal
<b>Operating voltage</b>	
• at AC-3 rated value maximum	400 V
<b>Operating current</b>	
• at AC-3	
— at 400 V rated value	15.5 A
<b>Operating power</b>	
• at AC-3	
— at 400 V rated value	7.5 kW
<b>No-load switching frequency</b>	15 1/s

#### Control circuit/ Control

<b>Type of voltage of the control supply voltage</b>	DC
<b>Control supply voltage 1</b>	
• at DC rated value	24 V

#### Auxiliary circuit

<b>Number of NC contacts for auxiliary contacts</b>	0
<b>Number of NO contacts for auxiliary contacts</b>	0
<b>Number of CO contacts</b>	
• for auxiliary contacts	0

#### Protective and monitoring functions

<b>Maximum short-circuit current breaking capacity (I<sub>cu</sub>)</b>	
• at 400 V rated value	50 kA

Short-circuit protection	
Product function Short circuit protection	Yes
Design of short-circuit protection	circuit-breakers
Installation/ mounting/ dimensions	
• (mounting position)	with vertical mounting surface +/-90° rotatable, with vertical mounting surface +/- 22.5° tiltable to the front and back
• (mounting type)	for snapping onto 60 mm busbar systems
Height	183 mm
Width	45 mm
Depth	154 mm
Busbar center-to-center spacing	60 mm
Required spacing	
• with side-by-side mounting	
— at the side	0 mm
• for grounded parts	
— forwards	10 mm
— Backwards	0 mm
— upwards	30 mm
— at the side	9 mm
• for live parts	
— forwards	10 mm
— Backwards	9 mm
— downwards	0 mm
— at the side	30 mm
Connections/Terminals	
Type of electrical connection	
• for main current circuit	screw-type terminals
Type of connectable conductor cross-sections	
• for main contacts	
— solid	1 ... 6 mm <sup>2</sup> , 2x (1 ... 2.5 mm <sup>2</sup> ), 2x (2.5 ... 6 mm <sup>2</sup> )
— stranded	1 ... 6 mm <sup>2</sup> , 2x (1 ... 2.5 mm <sup>2</sup> ), 2x (2.5 ... 6 mm <sup>2</sup> )
— finely stranded with core end processing	1 ... 6 mm <sup>2</sup> , 2x (1 ... 2.5 mm <sup>2</sup> ), 2x (2.5 ... 6 mm <sup>2</sup> )
• at AWG conductors for main contacts	2x (14 ... 10)
Connectable conductor cross-section for main contacts	
• single or multi-stranded	1 ... 6 mm <sup>2</sup>
• stranded	1 ... 6 mm <sup>2</sup>
• finely stranded with core end processing	1 ... 6 mm <sup>2</sup>
AWG number as coded connectable conductor cross section	
• for main contacts	14 ... 10

## Communication/ Protocol

<b>Protocol is supported</b>	
• PROFIBUS DP protocol	No
• PROFINET protocol	No
<b>Product function Bus communication</b>	No
<b>Protocol is supported</b>	
• AS-interface protocol	No

## Inputs/ Outputs

<b>Number of digital inputs</b>	0
---------------------------------	---

## Certificates/approvals

General Product Approval	For use in hazardous locations	Declaration of Conformity	Marine / Shipping
--------------------------	--------------------------------	---------------------------	-------------------



[Miscellaneous](#)



Marine / Shipping	other
-------------------	-------



LRS



RMRS



DNVGL.COM/AF

[Confirmation](#)

## Further information

### Information- and Downloadcenter (Catalogs, Brochures,...)

<http://www.siemens.com/industrial-controls/catalogs>

### Industry Mall (Online ordering system)

<https://mall.industry.siemens.com/mall/en/en/Catalog/product?mlfb=3RA1120-4AD26-0BB4>

### Cax online generator

<http://support.automation.siemens.com/WW/CAXorder/default.aspx?lang=en&mlfb=3RA1120-4AD26-0BB4>

### Service&Support (Manuals, Certificates, Characteristics, FAQs,...)

<https://support.industry.siemens.com/cs/ww/en/ps/3RA1120-4AD26-0BB4>

### Image database (product images, 2D dimension drawings, 3D models, device circuit diagrams, EPLAN macros, ...)

[http://www.automation.siemens.com/bilddb/cax\\_de.aspx?mlfb=3RA1120-4AD26-0BB4&lang=en](http://www.automation.siemens.com/bilddb/cax_de.aspx?mlfb=3RA1120-4AD26-0BB4&lang=en)

### Characteristic: Tripping characteristics, I<sup>2</sup>t, Let-through current

<https://support.industry.siemens.com/cs/ww/en/ps/3RA1120-4AD26-0BB4/char>

### Further characteristics (e.g. electrical endurance, switching frequency)

<http://www.automation.siemens.com/bilddb/index.aspx?view=Search&mlfb=3RA1120-4AD26-0BB4&objectype=14&gridview=view1>

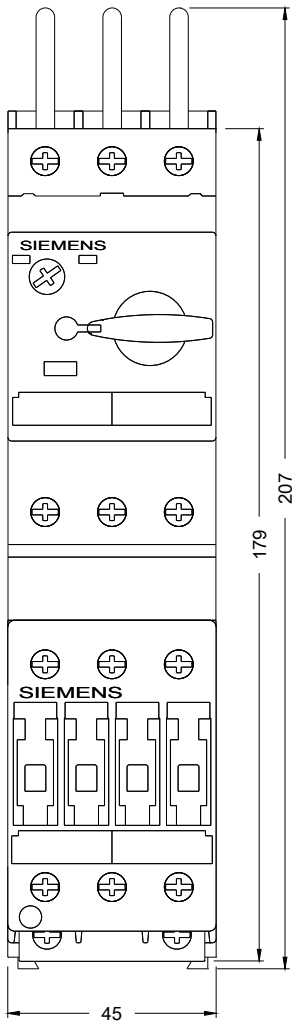

last modified:

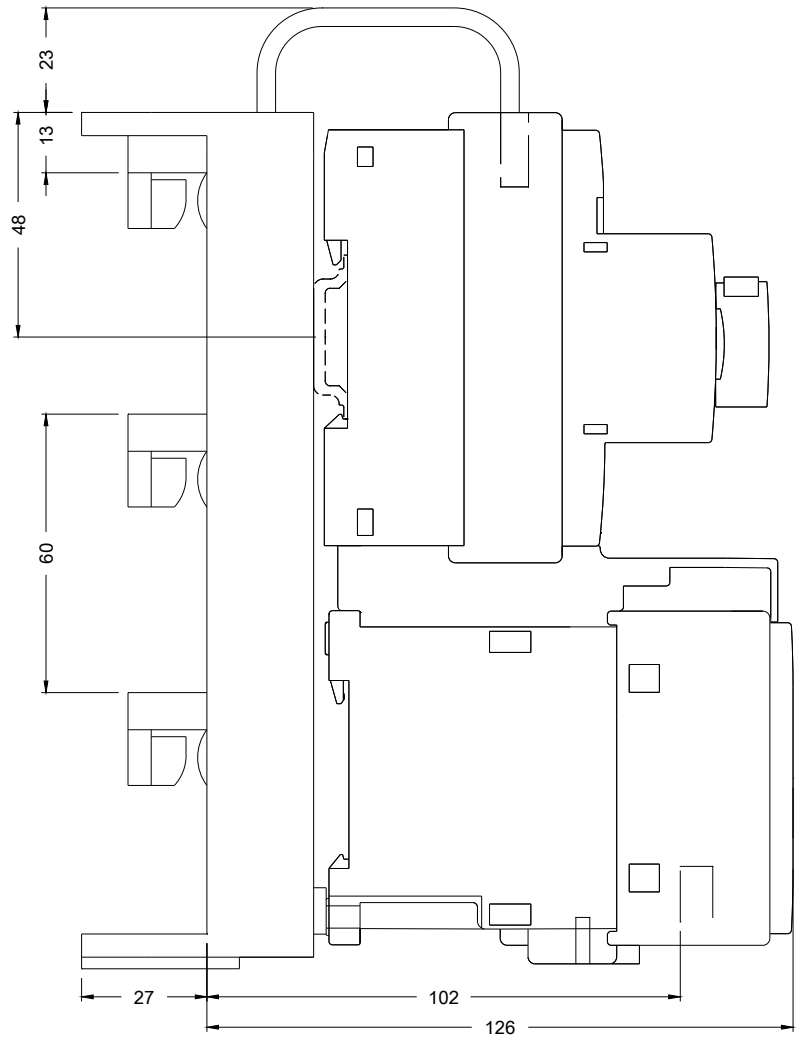

04/03/2019