

LV HRC fuse element, NH00, In: 63 A, gG, Un AC: 690 V, Un DC: 250 V, Front indicator, live grip lugs



Model	
Product brand name	SETRON
Product designation	LV HRC fuse link
Design of the product	With blade contacts
Design of an identification indicator	Front indicators
Design of the switching contact	Non-corroding, silver-plated
Design of the fuse link	LV HRC fuse link
General technical data	
Size of fuse system / acc. to DIN EN 60269-1	NH00
Operating class of the fuse link	gG
circuit-breaker / Design	3NA3
Supply voltage	
• at AC / rated value	690 V
• at DC	250 V
Protection class	
Protection class IP	IP20, with connected conductors
Switching capacity	
Switching capacity current	

- at DC / acc. to IEC 60947-2 / rated value 25 kA
- acc. to IEC 60947-2 / rated value 120 kA

### Dissipation

Power loss [W]	5.42 W
Power loss [W] / for rated value of the current / at AC / in hot operating state / per pole	5.42 W

### Electricity

Tripping residual / rated value / derated current / at 40 Cel	59.85 A
Diken-export / Let-through energy	DE_3NA_00_690_gG_63

### Mechanical Design

Width	
• of the enclosure	30 mm
(mounting position)	Any, preferably vertical
(net weight)	190 g

### Environmental conditions

Ambient temperature	
	-5 ... +40
• during storage	Air humidity 90% at 20 °C
Environmental category	-20 to +50 at 95% relative humidity

### Certificates

Reference code	
• acc. to DIN EN 61346-2	F
• acc. to DIN EN 81346-2	F

#### General Product Approval

#### Declaration of Conformity

#### Test Certificates



[Special Test Certificate](#)

[Type Test Certificates/Test Report](#)

[Miscellaneous](#)

#### Shipping Approval

#### other



[Environmental Confirmations](#)

[Miscellaneous](#)

### Further information

Information- and Downloadcenter (Catalogs, Brochures,...)  
<http://www.siemens.com/lowvoltage/catalogs>

**Industry Mall (Online ordering system)**

<https://mall.industry.siemens.com/mall/en/en/Catalog/product?mlfb=3NA3822-6>

**Service&Support (Manuals, Certificates, Characteristics, FAQs,...)**

<https://support.industry.siemens.com/cs/ww/en/ps/3NA3822-6>

**Image database (product images, 2D dimension drawings, 3D models, device circuit diagrams, ...)**

[http://www.automation.siemens.com/bilddb/cax\\_en.aspx?mlfb=3NA3822-6](http://www.automation.siemens.com/bilddb/cax_en.aspx?mlfb=3NA3822-6)

**CAX-Online-Generator**

<http://www.siemens.com/cax>

**Tender specifications**

<http://www.siemens.com/specifications>

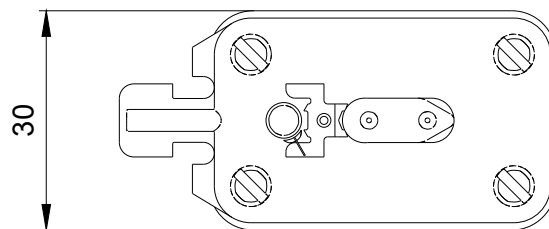
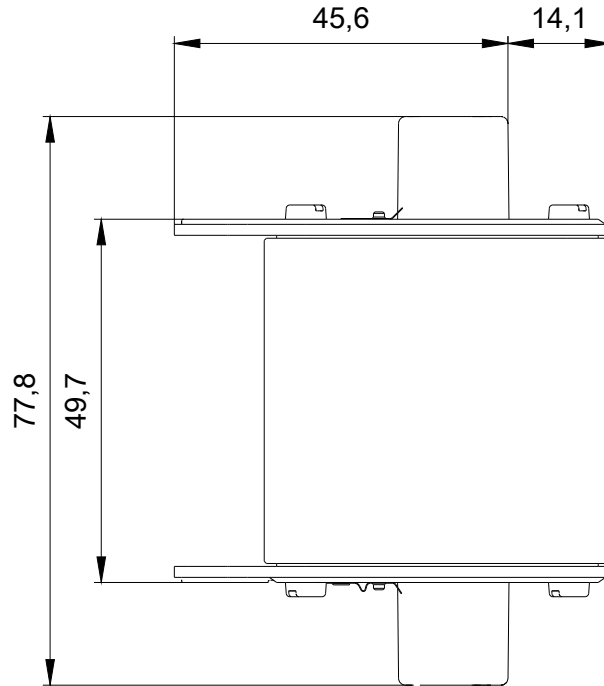

1

-F1



2

