

# 2/2-way-solenoid valve; servo assisted

Type 0290 / Article No. 85291

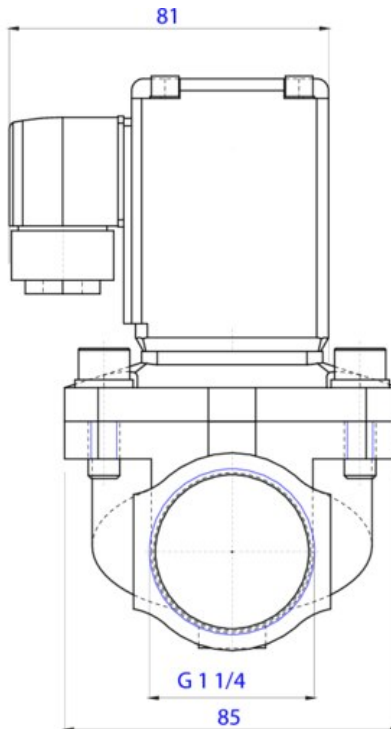

! Specific products may differ slightly from the general images shown. Please consider the **technical attributes**. ▶

Price per piece

**\$834.00**

🔄 Cable plug in delivery: enclosed



Shipping from 07/24/2023

How many would you like to order?

piece

1

Would you like to add suitable items?

Total amount: \$834.00

## Technical attributes

2/2 - A - normally closed - inlet port 1 (P/NC) | 32,00 mm (1 1/4 inch) | 0,00 bar - 12,00 bar | Brass | Inner thread - G1 1/4 | 24,00 V - 24,00 V | NBR (Nitrile rubber) | -10,00 °C - 80,00 °C | Valve complete

See your specific attribute group for technical details

- Most selected
- All
- Function
- Properties
- Orifice size (Kv value)
- Coil (Core)
- Process Connection Type/Size
- Materials
- Process Pressure / Temperature
- Voltage / Frequency
- Electrical Port Connection
- Sealing Material
- Standards and Regulations
- Protection Type

Select all attributes

<b>Function</b>	<input type="checkbox"/>
<b>Fluidic port connection number</b> 2	<input type="checkbox"/>

<b>Valve function number of switching positions</b> 2	<input type="checkbox"/>
<b>Valve function</b>	<input type="checkbox"/>
<b>Manual actuation</b> No	<input type="checkbox"/>

 <b>Process Connection Type/Size</b>	<input type="checkbox"/>
<b>Port connection 1 type</b> Inner thread	<input type="checkbox"/>
<b>Port connection 1 thread marking</b> 1 1/4	<input type="checkbox"/>
<b>Port connection 1 thread type</b> G	<input type="checkbox"/>

 <b>Voltage / Frequency</b>	<input type="checkbox"/>
<b>Voltage min / rated voltage</b> 24 V	<input type="checkbox"/>
<b>Voltage max / rated voltage</b> 24 V	<input type="checkbox"/>
<b>Voltage frequency</b> 50/60 Hz	<input type="checkbox"/>
<b>AC voltage</b> Yes	<input type="checkbox"/>
<b>DC voltage</b> Yes	<input type="checkbox"/>

 <b>Materials</b>	<input type="checkbox"/>
<b>Main valve wetted material</b> Brass	<input type="checkbox"/>

 <b>Process Pressure / Temperature</b>	<input type="checkbox"/>
<b>Nominal pressure min</b> 0 bar	<input type="checkbox"/>
<b>Nominal pressure max (liquid)</b> 12 bar	<input type="checkbox"/>
<b>Temperature medium min</b> -10 °C	<input type="checkbox"/>
<b>Temperature medium max</b> 80 °C	<input type="checkbox"/>
<b>Temperature environment max</b> 55 °C	<input type="checkbox"/>

 <b>Sealing Material</b>	<input type="checkbox"/>
<b>Seat seal material</b> NBR (Nitrile rubber)	<input type="checkbox"/>
<b>Sealing toward outside material</b> NBR (Nitrile rubber)	<input type="checkbox"/>

 <b>Orifice size (Kv value)</b>	<input type="checkbox"/>
<b>Kv value (water)</b> 16 m <sup>3</sup> /h	<input type="checkbox"/>
<b>Qn value (gas)</b> 17.300 l/min	<input type="checkbox"/>
<b>Pilot control orifice (mm)</b> 2 mm	<input type="checkbox"/>
<b>Main valve orifice 1 (P) (mm)</b> 32 mm	<input type="checkbox"/>

 <b>Properties</b>	<input type="checkbox"/>
<b>Type</b> 0290	<input type="checkbox"/>
<b>Actuator type</b> Plunger valve	<input type="checkbox"/>
<b>Media separation</b> No	<input type="checkbox"/>
<b>Flow</b> Above seat	<input type="checkbox"/>
<b>Valve construction</b> Valve complete	<input type="checkbox"/>
<b>Switch function</b> on/off	<input type="checkbox"/>
<b>Vacuum version</b> Yes	<input type="checkbox"/>
<b>Analysis version</b> No	<input type="checkbox"/>
<b>Installation length</b> 126 mm	<input type="checkbox"/>

 <b>Electrical Port Connection</b>	<input type="checkbox"/>
<b>Electrical connection sort</b> Plug pattern form A according to DIN EN 175301-803	<input type="checkbox"/>
<b>Cable plug in delivery</b> enclosed	<input type="checkbox"/>

 <b>Protection Type</b>	<input type="checkbox"/>
<b>Protection type (IP max. with suitable connector)</b> IP65	<input type="checkbox"/>

## Downloads

Filter for Document type

[All](#)[Data Sheets](#)[User Manuals](#)[Declaration of Conformity](#)[EU Material Compliance](#)[Functional Safety](#)

Filter for Languages ▼

## Data Sheets

## Type 0290 data sheet | servo-assisted diaphragm valve

pdf (963 kB) EN / EU

<https://www.burkert.com/en/Media/plm/DTS/DS/DS0290-Standard-EU-EN.pdf>

## User Manuals

## Additional Manual Type 0131 0255 0256 0283 0287 0290 0293 2610 | El. operating conditions

pdf (129 kB) EN,FR,DE / EU

<https://www.burkert.com/en/Media/plm/MAN/MA/MA0131-Supplement-EU-ML.pdf>

## User Manuals

## Additional manual Type 6013 | PX01 - PX03 Use in the explosion-hazard area

pdf (122 kB) EN,FR,DE / EU

<https://www.burkert.com/en/Media/plm/MAN/MA/MA6013-CodePX01-03-EU-ML.pdf>

## Data Sheets

## Typ 0290 Datenblatt | servogesteuertes Membranventil

pdf (972 kB) DE / DE

<https://www.burkert.com/en/Media/plm/DTS/DS/DS0290-Standard-DE-DE.pdf>

## Data Sheets

## Type 0290 | FICHE TECHNIQUE | Vanne à membrane 2/2 voies pilotée

pdf (852 kB) FR / FR

<https://www.burkert.com/en/Media/plm/DTS/DS/DS0290-Standard-FR-FR.pdf>

## Helpful tools & videos



## resistApp - Chemical Resistance App

(/en/resistapp/show)



## Fluid Calculator

(/en/calculator)

## Accessories & Spare part sets

Select a group to concentrate on it

All

Accessories

Spare part sets

### Accessories

Here you will find suitable accessories for your item. Please note the technical features.

## valve connector typ A

Article number 314807

Type 2518

(/en/products/solenoid-valves/accessories/cable-plugs/314807)

**\$35.00**

Cable plug | Form A according to DIN EN 175301-803 | 3.000,00 mm | 0,00 V - 250,00 V | 10,00 A | -25,00 °C - 85,00 °C | IP65/67

## Spare part sets

Here you will find spare and wearing parts for your item. Please note the technical features.

### Sketch Spare part sets

Click to zoom

### 1 Spare part sets

## Coil Set 024/UC NBR MS/VA

Article number 245861

Type SET1

(/en/item/245861)

**\$336.00**

### 2 Spare part sets